



Ada Lovelace C of E High School

Dear Parent/Carer,

We are writing to introduce our School Fund to you. This is a fund operated in all Trust Schools and the Ada Lovelace Governing Body will manage it to fund projects over and above what would otherwise be possible.

Our School Fund is built up from financial donations from parents/carers and is held in a separate bank account to other funding. It has a very important function which helps pay for additional facilities and development projects.

Use of the School Fund will be decided by the Governing Body in consultation with the Parents and Teachers Association (the PTA), of which you are all members. The fund-raising aim of the PTA is to support our departments in school with the purchasing of additional equipment and resources that enrich our provision. The School Fund part or fully funds larger, more long-term investments in the fabric of the school.

The money raised by the School Fund has already funded the Ada Lovelace themed sculpture for the playground to inspire the pupils and create our Ada Lovelace identity, as well as the stone benches for two areas in the playground. It has also provided the capital funding for the school garden, the amazing artwork in the school chapel and the fit out of the Inclusion room providing an inviting and calming space.

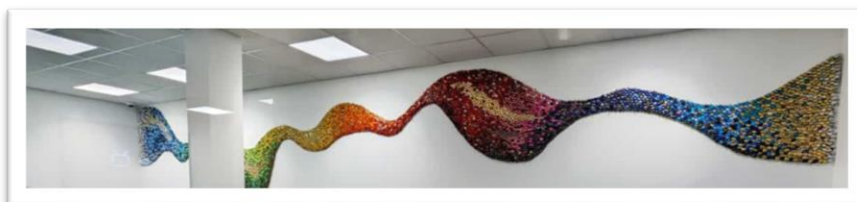
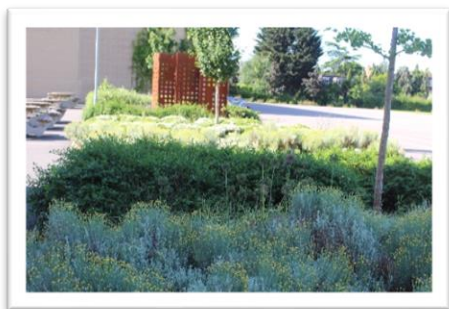

CEO

Dame Alice Hudson

Headteacher

Mr Keir Smith

Ada Lovelace Church of England High School

Park View Road | Ealing | London | W5 2JX | t: (0)20 3540 0200

e: office@adalovelace.org.uk | w: www.adalovelace.org.uk

During the current academic year, the School Fund made an important contribution towards the new Astro Pitches, as well as funding the bookshelves for the new library.



During the next academic year, we intend to use the School fund to provide more outside covered space to allow the café to spill outside, creating more shelter for our students.

Donations can be one off, annually, or monthly. The following are suggested amounts for monthly contributions.

- £10.00 monthly for each pupil (equivalent to a cup of coffee a week)
- £20.00 monthly for each pupil (equivalent to one primary school breakfast club a week)
- £30.00 monthly for each pupil (equivalent to one primary school after school club a week)

It's amazing what a little from a lot of people can do.

Below is the link to the online giving page. Please be sure to select Ada Lovelace School Fund to ensure your donation supports the correct school. We also strongly encourage you to complete the Gift Aid Form if you pay UK income tax. By doing so you will add 25% to the value of your donation.

If you have any questions about the School Fund, please contact Mrs Hamri via email on schoolfund@adalovelace.org.uk

Thank you for supporting your child's education, and that of all the students at Ada Lovelace CofE High School, part of the Twyford CofE Academies Trust.

Kind Regards

Mr Keir Smith & Mrs Emma Harniman

CEO
Dame Alice Hudson

Headteacher
Mr Keir Smith

Ada Lovelace Church of England High School
Park View Road | Ealing | London | W5 2JX | t: (0)20 3540 0200
e: office@adalovelace.org.uk | w: www.adalovelace.org.uk