

Setting up a parent account for Evidence Me

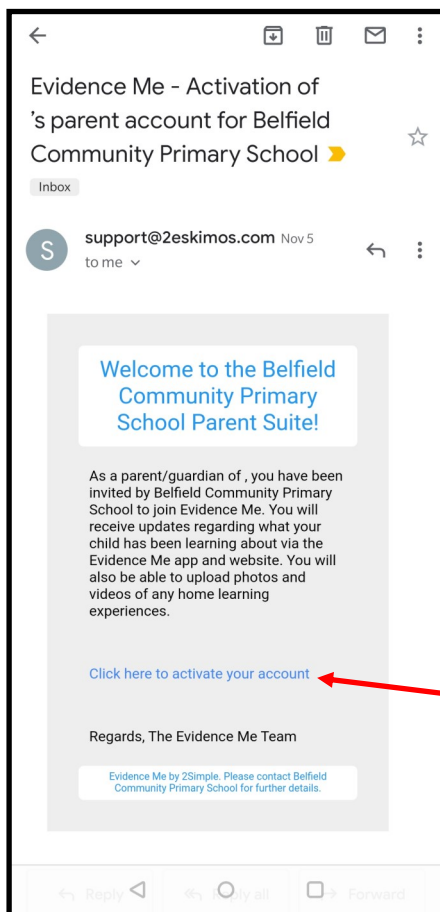

When you have given your email address to the teacher, they will add your details to your child's profile.

You will receive this email.

Click on the link.

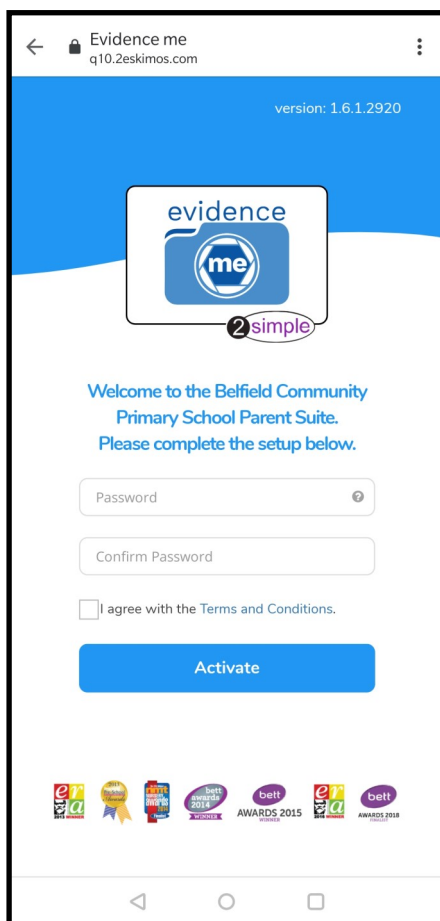

You will need to choose a password to set up your account.

Please keep it safe!

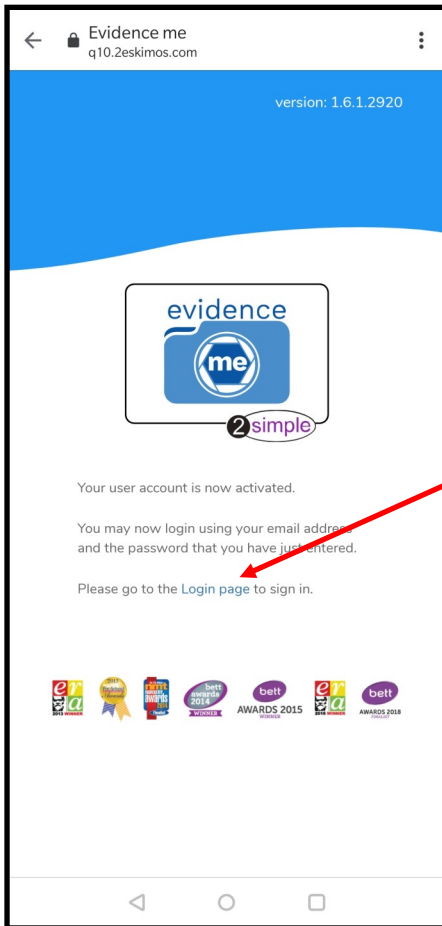

You will now have set up your account.

Log on to it here and use your email address and password.

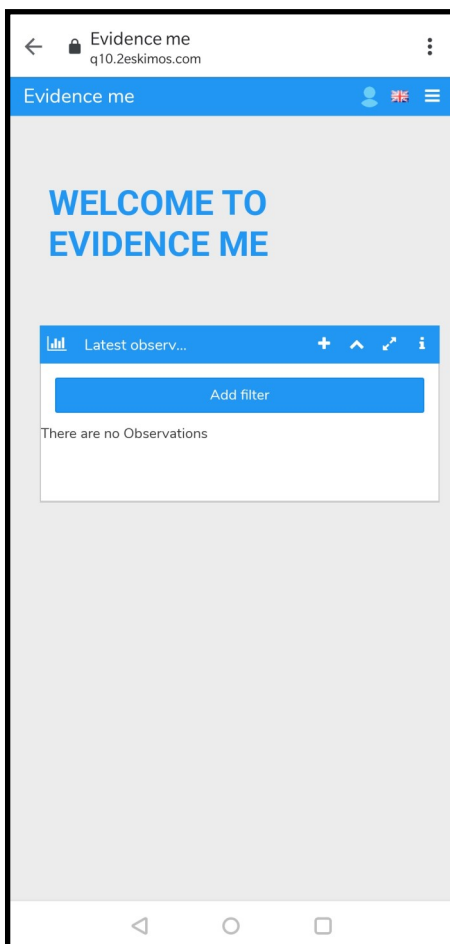

This is what your child's profile will look like when you log on.

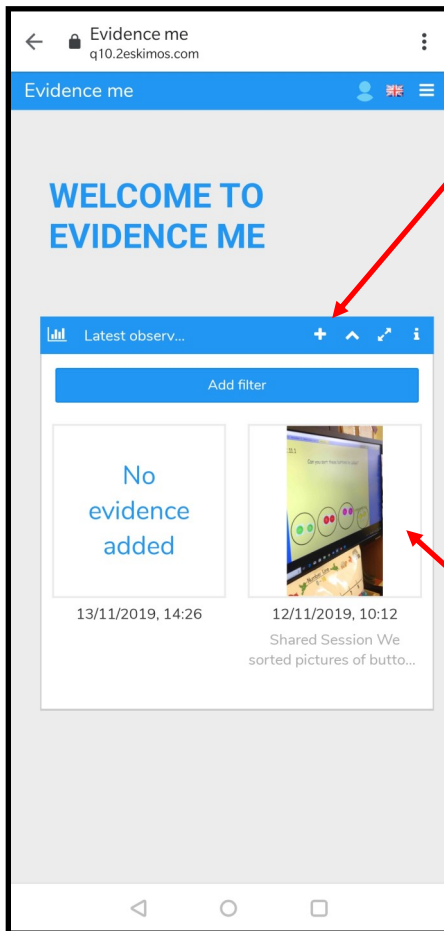

You can add pictures of your children from home by clicking here.

Observations of your children from school will come up here. Click on them and see more information.

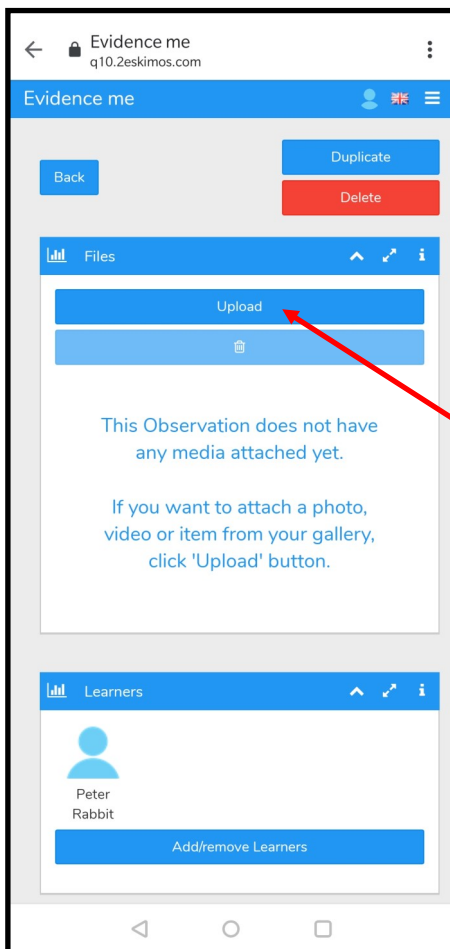

If you click to add a photograph it will take you to this page.

Click to upload a photograph.

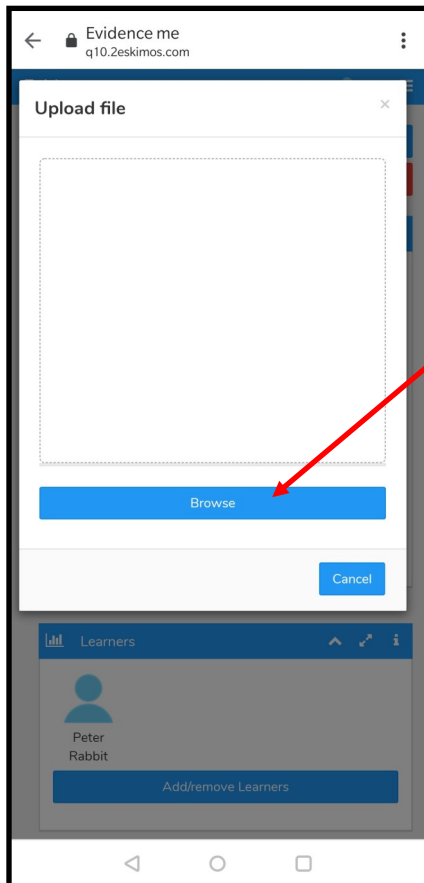

You can browse for a photograph or video you have on your phone, or take a new one.

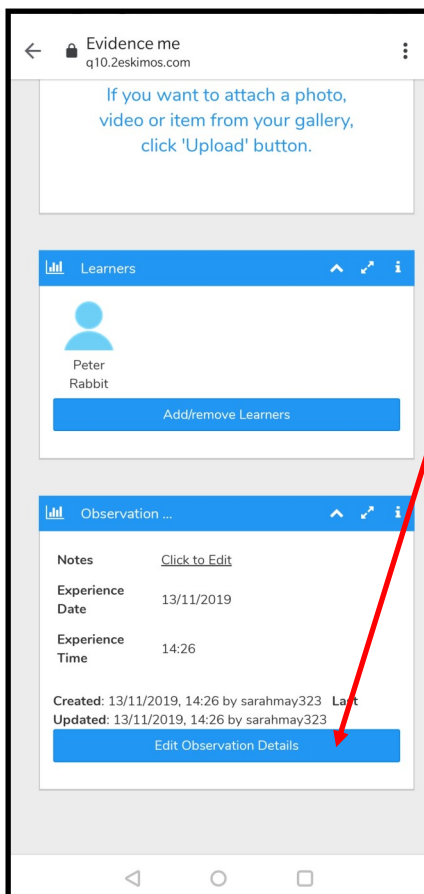

You can add parent notes about what they have done and then click 'save changes.'

