

All 4 Parental Controls

Controls & Settings guide

All 4 Parental Controls allows you to set a PIN on your account to restrict access to content. You can set a PIN on one or two levels: All rated content (16+ years of age only) or 18 rated content only (18+ years of age only). Age ratings are set by the [BBFC](#) .



What do I need?

A username and password for your All 4 account.

Restrictions you can apply



File Sharing & Hacking



Inappropriate content

Step by Step instructions

1. Go to www.channel4.com and select "Sign in to My4".

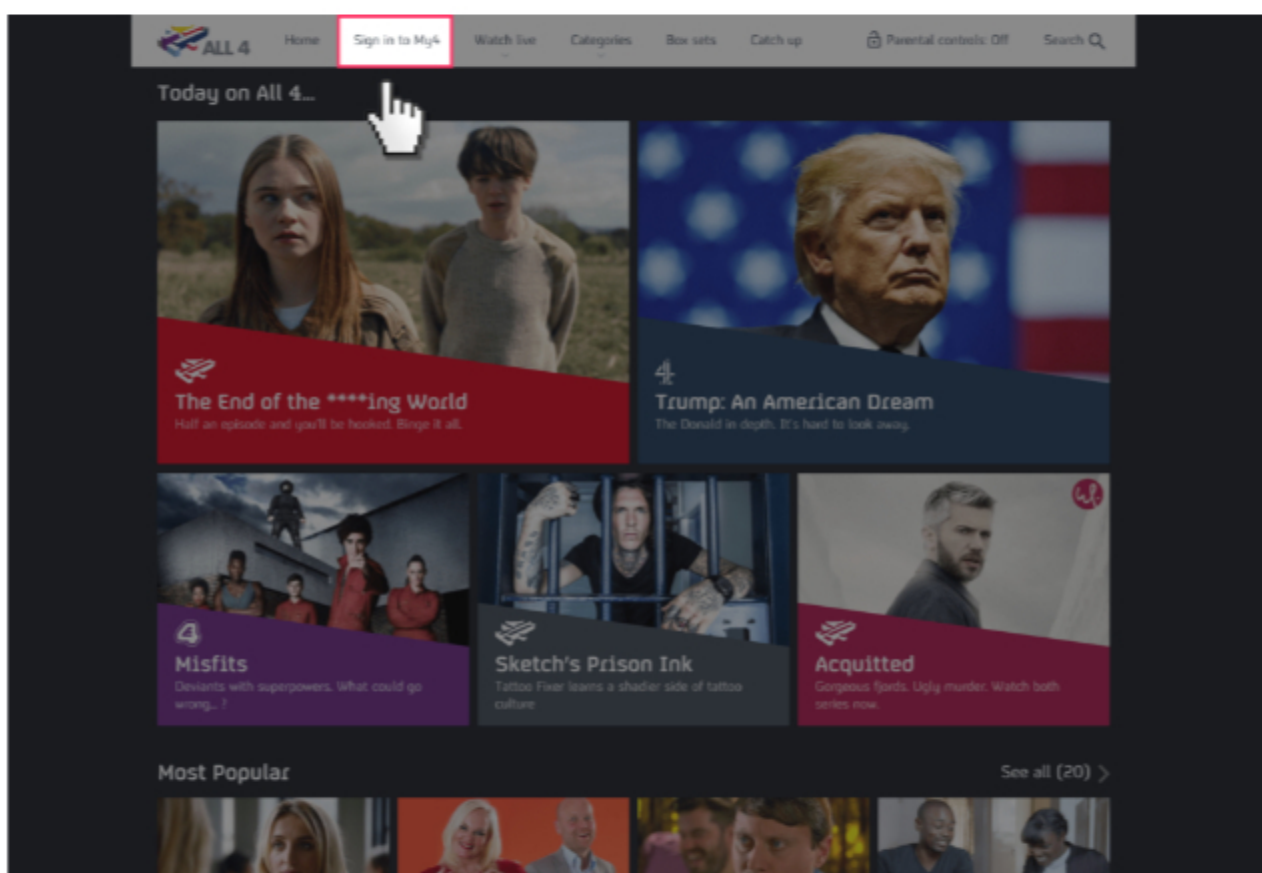

2. If you have registered an account, then enter your Email address and account Password.

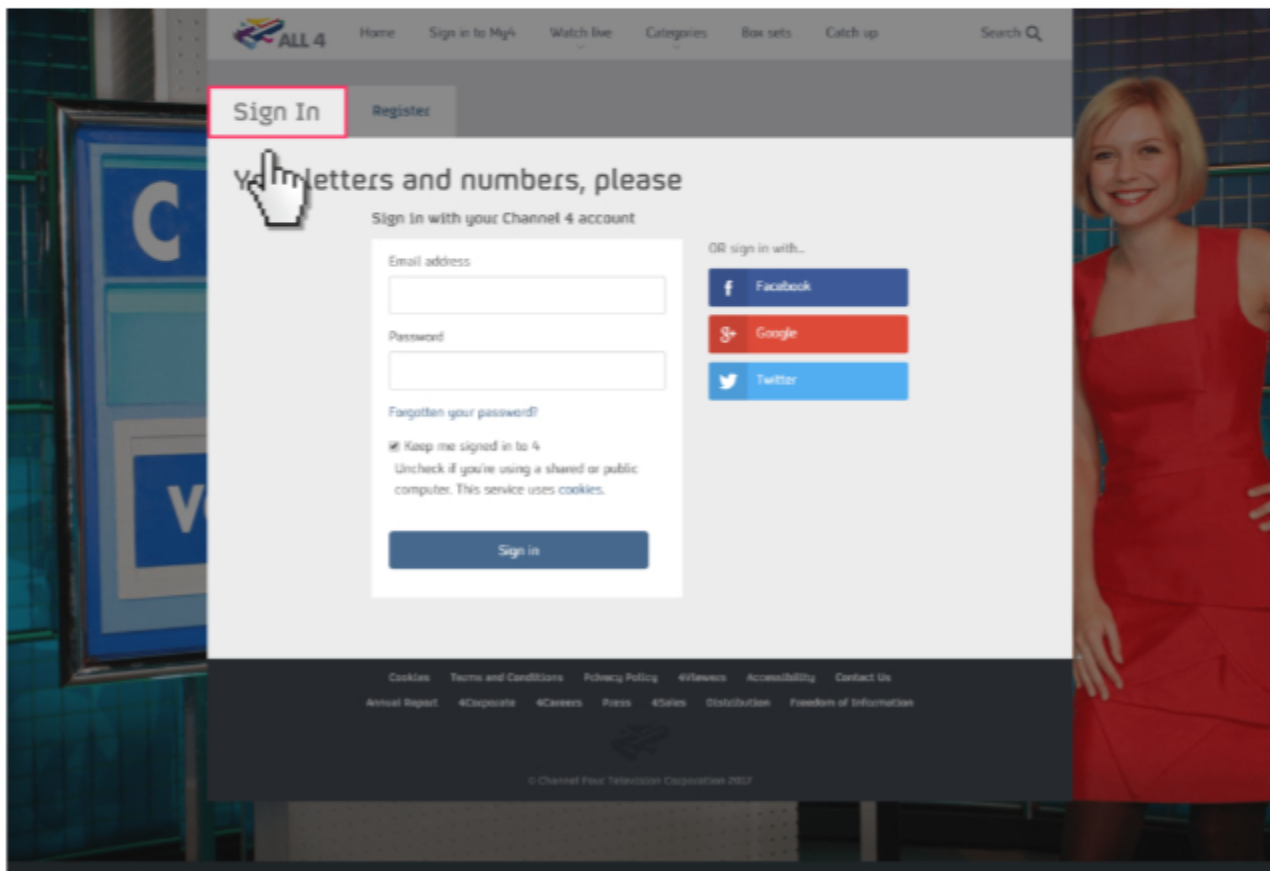

3. If you have not registered an account then select “Register” and enter your details to create an account.

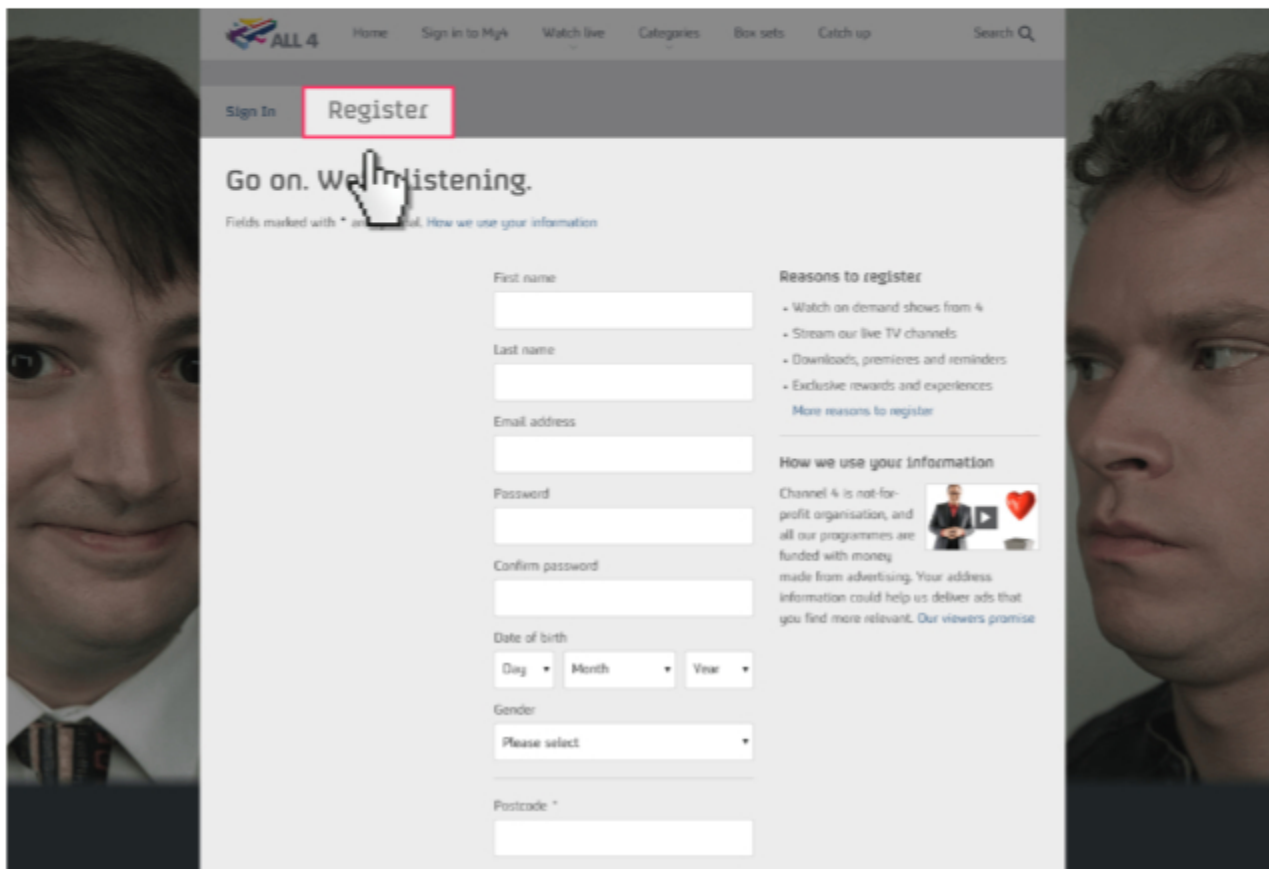

ALL 4 Home Sign in to My4 Watch live Categories Box sets Catch up Search Q

Sign In **Register**

Go on. We're listening.

Fields marked with * are required. [How we use your information](#)

First name

Last name

Email address

Password

Confirm password

Date of birth
Day Month Year

Gender

Postcode *

Reasons to register

- Watch on demand shows from 4
- Stream our live TV channels
- Downloads, premieres and reminders
- Exclusive rewards and experiences

[More reasons to register](#)

How we use your information

Channel 4 is not-for-profit organisation, and all our programmes are funded with money made from advertising. Your address information could help us deliver ads that you find more relevant. Our viewers promise



4. Once signed in select "Parental Controls".

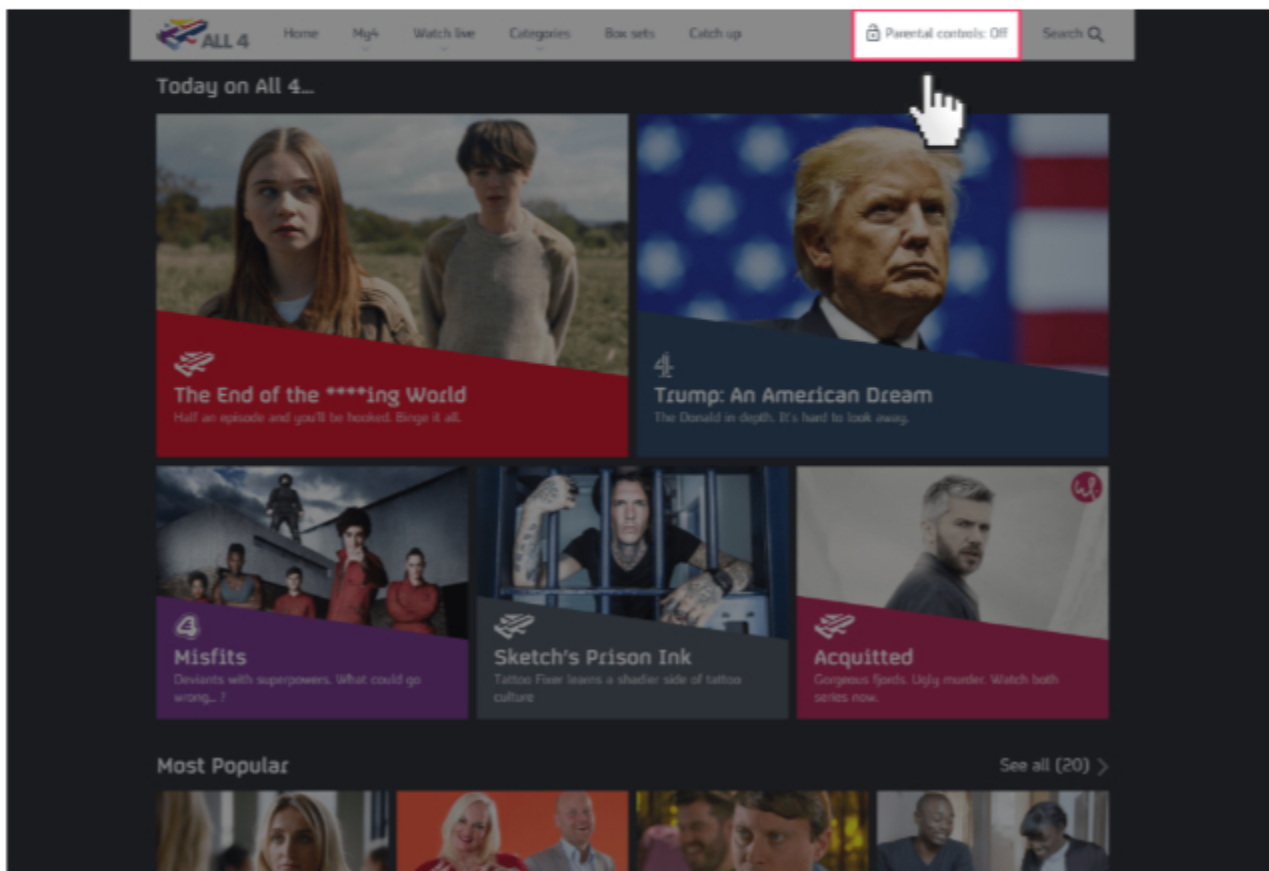

5. Select to set a PIN for 16+ or 18+ content.

ALL 4 Home My4 Watch live Categories Box sets Catch up Search Q

Parental Controls

Set-up PIN protection

Your PIN can be set at one of two levels: All rated content (16+ years of age only) or 18 rated content only (18+ years of age only)

16 All rated content (16 and 18) **18 At 18**

If you choose to set it for All rated content (16+), then anyone wishing to view content suitable only for users over 16 years of age will need the PIN. If you choose to set it at 18 rated content (18+), then anyone wishing to view content suitable only for users over 18 years of age will need the PIN.

Your PIN will be required in order to view rated content each time you log on to Channel4.com but only once per session. You'll have to enter your PIN for each programme you want to view, but you can watch as many episodes of that programme you like without being prompted for your PIN again (until you close your browser to end your session).

If you share your PIN with, or allow your PIN to be accessed by, anyone else and it is entered by them, then all content on Channel4.com will be accessible, including 18 rated content suitable only for adults. Please keep your PIN secure.

1. Set PIN for

- 16** All rated content (16+)
- 18** 18 rated content (18+)

2. Enter PIN
Please enter your chosen 4-digit PIN

Your pin must consist of 4 numbers.

I confirm that I have read the Terms and Conditions, and that I am 18 years of age or older.

Enable PIN Access

PIN Protected Content

Channel4.com provides access to content reflecting the broad range of Channel 4's programmes which may be unsuitable for younger viewers.

6. Enter a 4-digit PIN that you will need to use to access content above the age rating you have selected.

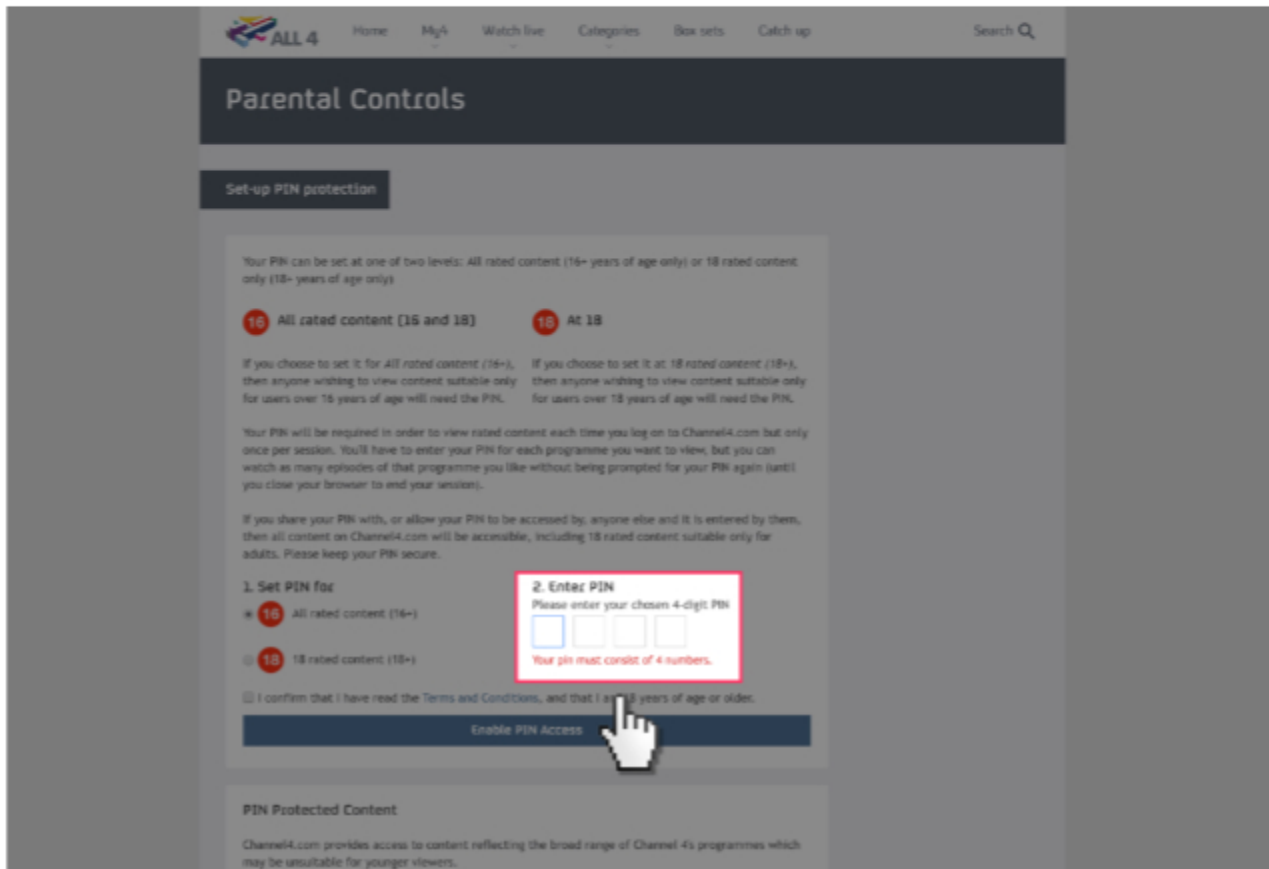

The screenshot shows the Channel 4 website's 'Parental Controls' section. At the top, there is a navigation bar with the Channel 4 logo and links for Home, My4, Watch live, Categories, Box sets, and Catch up. A search icon is also present. Below the navigation bar is a dark grey header with the text 'Parental Controls'. Underneath this is a sub-header 'Set-up PIN protection'. The main content area explains that the PIN can be set for 'All rated content (16+ years of age only)' or '18 rated content only (18+ years of age only)'. Two options are presented: '16 All rated content (16 and 18)' and '18 At 18'. The '16' option is selected with a radio button. Below these options, there is a section titled '1. Set PIN for' with two radio buttons: '16 All rated content (16+)' (selected) and '18 18 rated content (18+)'. To the right of this section is a box titled '2. Enter PIN' which contains four empty input fields for a 4-digit PIN and a red error message: 'Your pin must consist of 4 numbers.' Below the PIN input fields is a checkbox for 'I confirm that I have read the Terms and Conditions, and that I am 16 years of age or older.' At the bottom of the form is a dark blue button labeled 'Enable PIN Access' with a hand cursor icon pointing to it. Below the form is a section titled 'PIN Protected Content' which states: 'Channel4.com provides access to content reflecting the broad range of Channel 4's programmes which may be unsuitable for younger viewers.'

7. Confirm the Terms and Conditions and then Enable PIN Access.

ALL 4 Home My4 Watch live Categories Box sets Catch up Search

Parental Controls

Set-up PIN protection

Your PIN can be set at one of two levels: All rated content (16+ years of age only) or 18 rated content only (18+ years of age only)

16 All rated content (16 and 18) **18 At 18**

If you choose to set it for All rated content (16+), then anyone wishing to view content suitable only for users over 16 years of age will need the PIN. If you choose to set it at 18 rated content (18+), then anyone wishing to view content suitable only for users over 18 years of age will need the PIN.

Your PIN will be required in order to view rated content each time you log on to Channel4.com but only once per session. You'll have to enter your PIN for each programme you want to view, but you can watch as many episodes of that programme you like without being prompted for your PIN again (until you close your browser to end your session).

If you share your PIN with, or allow your PIN to be accessed by, anyone else and it is entered by them, then all content on Channel4.com will be accessible, including 18 rated content suitable only for adults. Please keep your PIN secure.

1. Set PIN for

16 All rated content (16+)

18 18 rated content (18+)

2. Enter PIN
Please enter your chosen 4-digit PIN

Your pin must consist of 4 numbers.

I confirm that I have read the Terms and Conditions, and that I am 18 years of age or older.

Enable PIN Access

Protected Content

Channel4.com provides access to content reflecting the broad range of Channel 4's programmes which may be unsuitable for younger viewers.

8. You have now enabled your PIN.

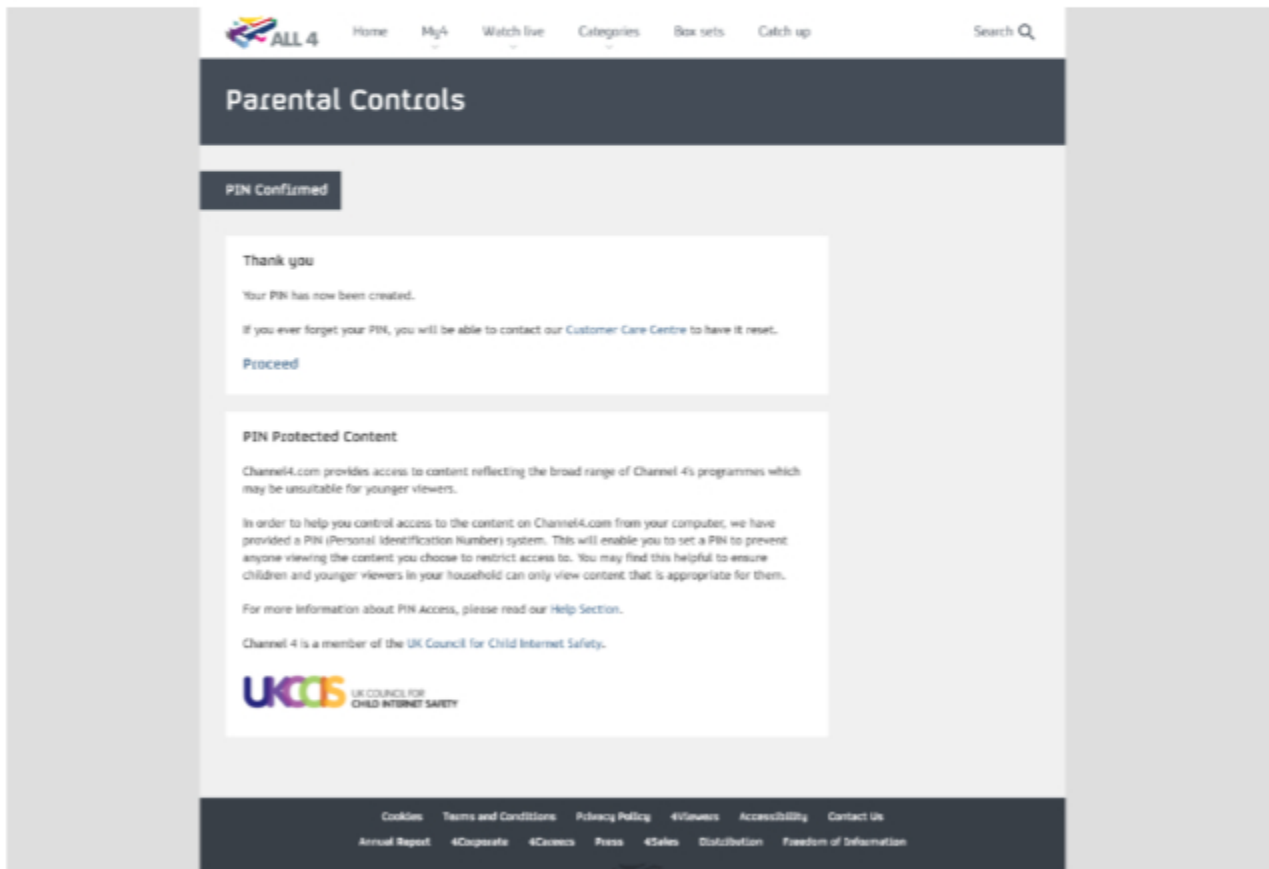

The screenshot shows the Channel 4 website's 'Parental Controls' page. At the top, there is a navigation bar with the Channel 4 logo and links for Home, My4, Watch live, Categories, Box sets, and Catch up. A search icon is located on the right. Below the navigation bar is a dark header with the text 'Parental Controls'. A dark box with the text 'PIN Confirmed' is positioned above a white message box. The message box contains the following text: 'Thank you', 'Your PIN has now been created.', 'If you ever forget your PIN, you will be able to contact our Customer Care Centre to have it reset.', and a blue 'Proceed' button. Below this is a section titled 'PIN Protected Content' with a paragraph explaining that Channel 4.com provides access to content reflecting the broad range of Channel 4's programmes which may be unsuitable for younger viewers. It states that a PIN (Personal Identification Number) system has been provided to help control access to content on Channel 4.com from a computer, allowing users to set a PIN to prevent anyone viewing the content they choose to restrict access to. It also mentions that this is helpful to ensure children and younger viewers in a household can only view content that is appropriate for them. A link to the 'Help Section' is provided for more information about PIN Access. At the bottom of the message box, it states that Channel 4 is a member of the UK Council for Child Internet Safety, accompanied by the UKCIS logo. The footer of the website contains a list of links: Cookies, Terms and Conditions, Privacy Policy, 4Viewers, Accessibility, Contact Us, Annual Report, 4Corporate, 4Careers, Press, 4Sales, Distribution, and Freedom of Information.

ALL 4 Home My4 Watch live Categories Box sets Catch up Search

Parental Controls

PIN Confirmed

Thank you

Your PIN has now been created.

If you ever forget your PIN, you will be able to contact our Customer Care Centre to have it reset.

[Proceed](#)

PIN Protected Content

Channel4.com provides access to content reflecting the broad range of Channel 4's programmes which may be unsuitable for younger viewers.

In order to help you control access to the content on Channel4.com from your computer, we have provided a PIN (Personal Identification Number) system. This will enable you to set a PIN to prevent anyone viewing the content you choose to restrict access to. You may find this helpful to ensure children and younger viewers in your household can only view content that is appropriate for them.

For more information about PIN Access, please read our [Help Section](#).

Channel 4 is a member of the UK Council for Child Internet Safety.

 UK COUNCIL FOR CHILD INTERNET SAFETY

[Cookies](#) [Terms and Conditions](#) [Privacy Policy](#) [4Viewers](#) [Accessibility](#) [Contact Us](#)
[Annual Report](#) [4Corporate](#) [4Careers](#) [Press](#) [4Sales](#) [Distribution](#) [Freedom of Information](#)