

## How to use the Evidence for Learning family app

1. Go to the App Store (on an iPhone) or the Google Play Store (on an Android phone).



2. Search for 'Evidence for Learning Family'.

Make sure you download the Family version (pink stripe on logo) and not the School version (blue stripe on logo)!



3. Once the app is downloaded, you will be able to log in via the screen pictured below. You will have been sent the Domain and Username via email. The domain is haymerle (without a capital letter) and your username will be your email address. You will not have to log in again unless you change your details or need to reset your password.

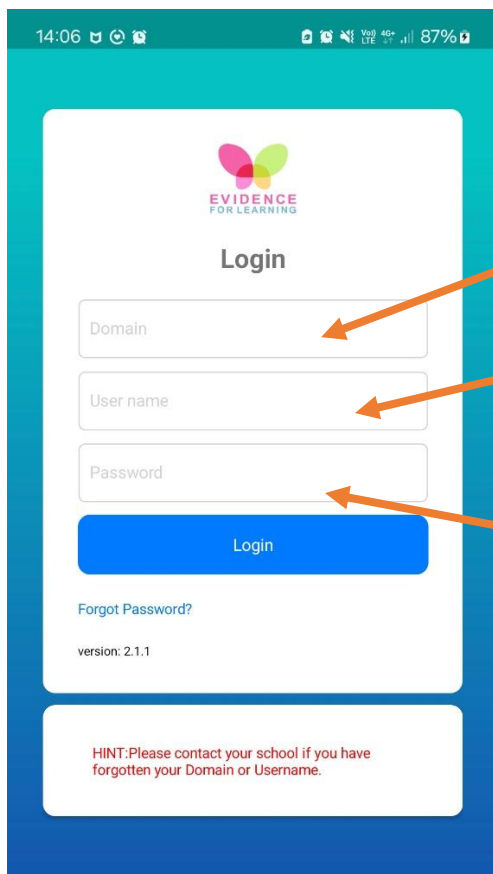

Domain name: **haymerle**

Username: **The email address that you gave us**

Password: This will come from Evidence for Learning – please check you spam and junk folders in your emails too.

When you open the screen you will need to log in with your own email address and the password which will have been sent to you from Evidence for Learning

This is what your home page will look like:

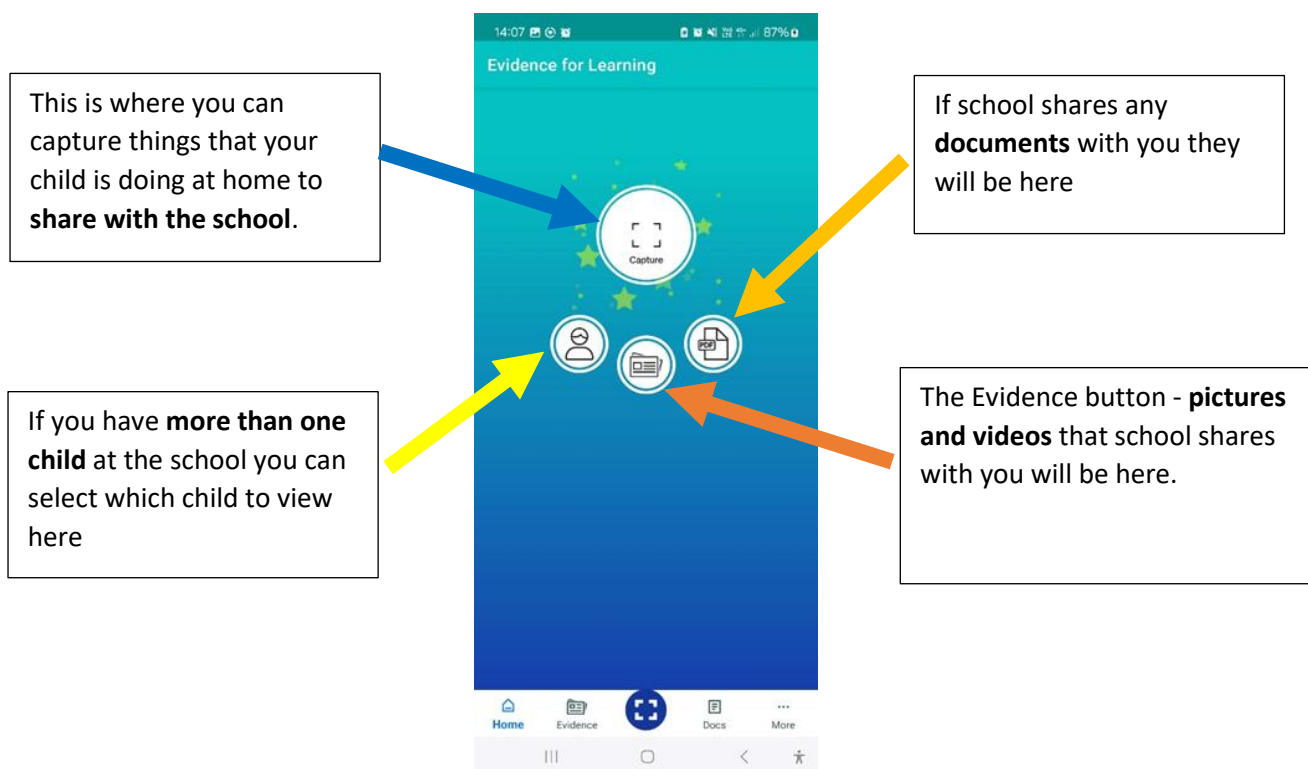

This is where you can capture things that your child is doing at home to **share with the school.**

If school shares any **documents** with you they will be here

If you have **more than one child** at the school you can select which child to view here

The Evidence button - **pictures and videos** that school shares with you will be here.

When you click on the evidence button this will open the page where you can see all the evidence the teacher has shared with you

## How to view Evidence



To look at the evidence that has been shared with you click on the evidence button in the middle of the screen.

Or

the evidence button on the bottom of the app



To view each of the samples of work that have been shared with you click on each to open

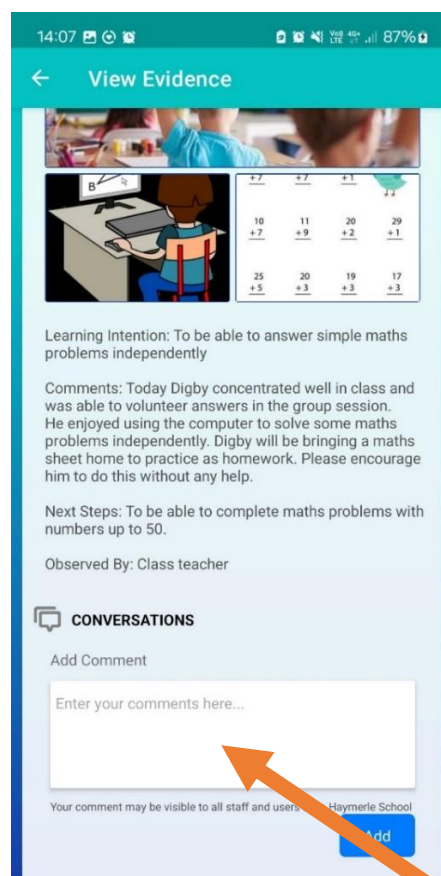
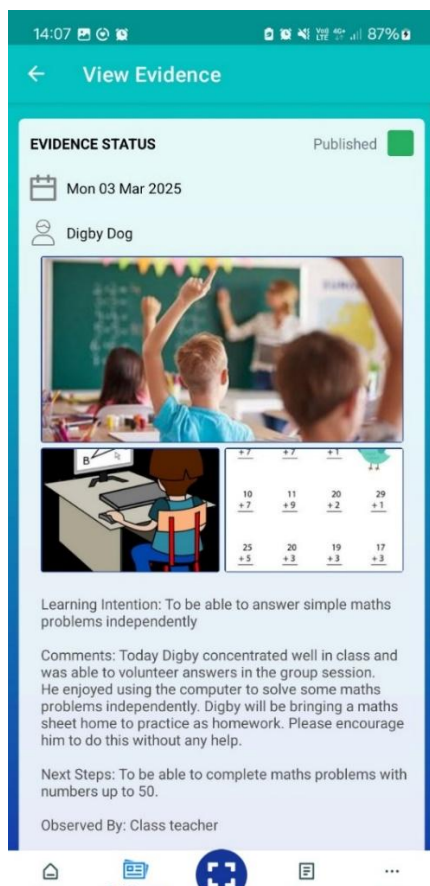

You are also able to add a comment about the work that has been shared with you.

The class staff team will be able to read what you have shared about the progress that your child is making.

## How to share Evidence



To share evidence with us  
either click on the capture  
button here

**Or**  
here

To open this page

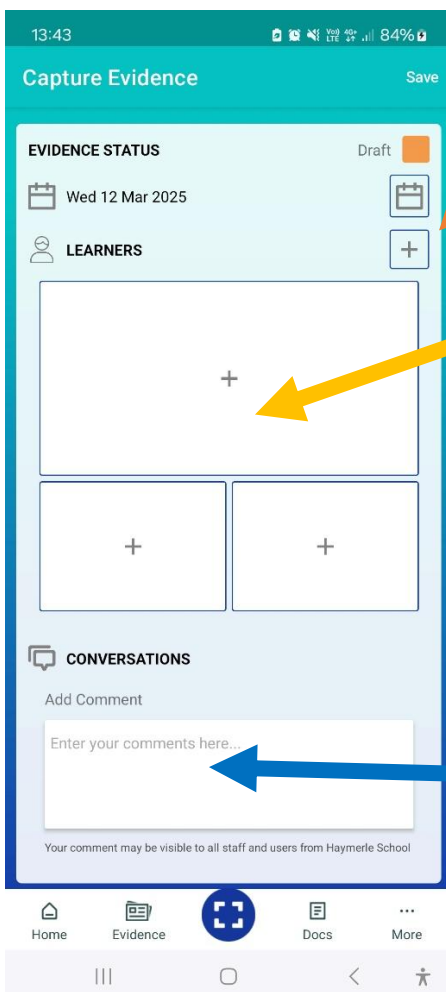

1 Add the learner (you can add both learners if you have  
two at our school)

2. add photos or videos here – you can add up to 3 photos  
or short videos at a time. You will have the choice of adding  
them from your library or taking a photo or video

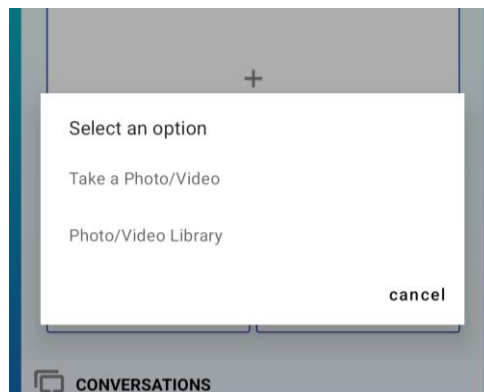

3. type in a comment about what you are sharing with the  
school here if you want to.

When you have uploaded the evidence that you want to share with us

Click on the Draft button

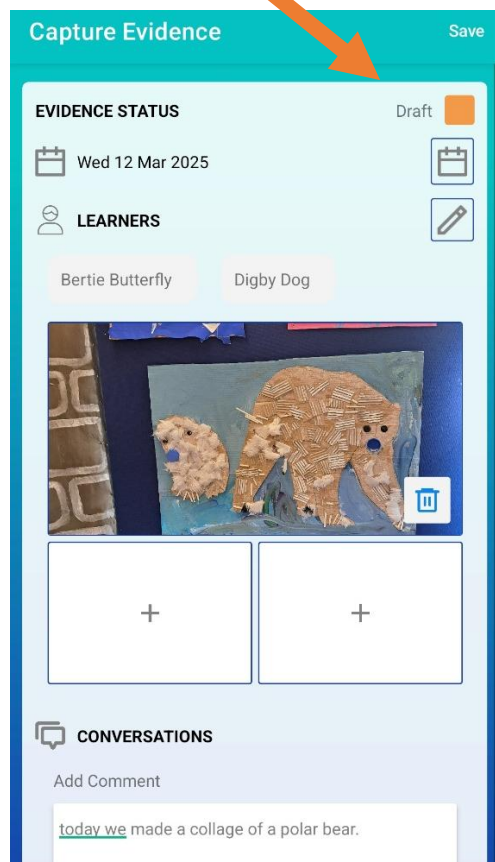

to make it published and then press save

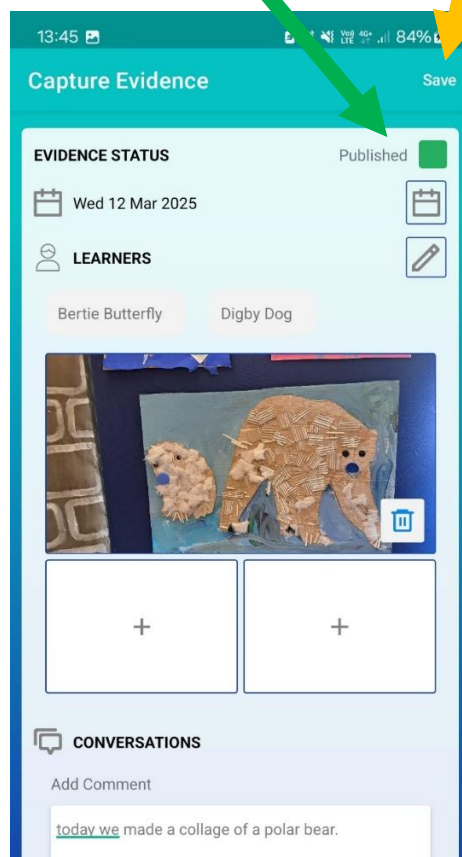

Your evidence will now be available for the class team and staff at Haymerle School to see.

## Other Features you can access.



On the home screen at the bottom you will see a more button

Click on this to open the following pages

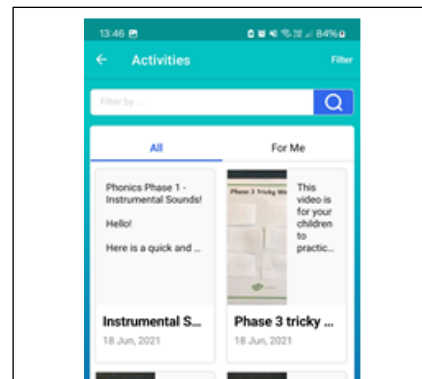
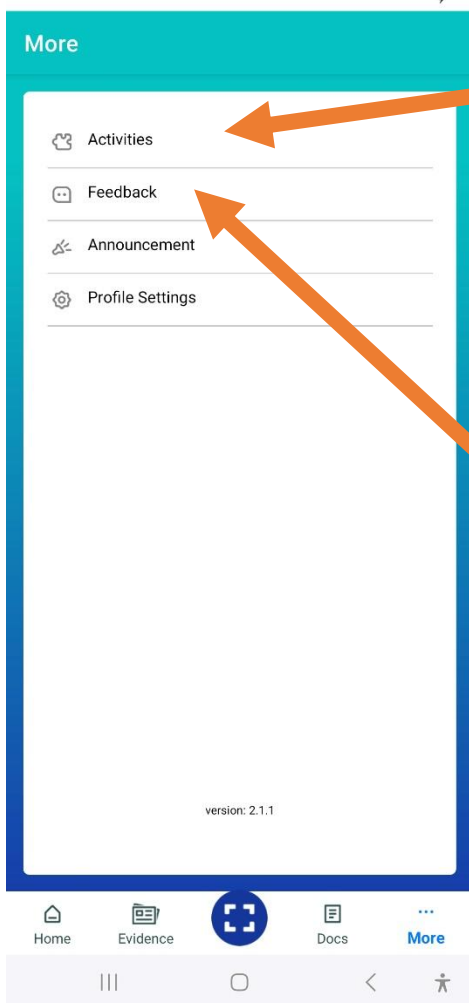

Activities that have been shared by the class team

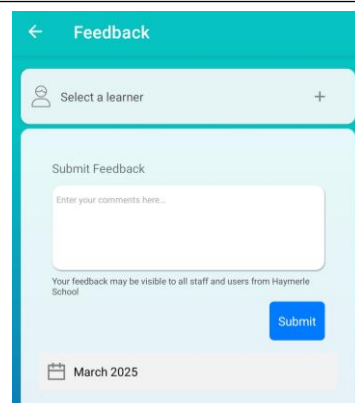

Somewhere to write feedback about what your child has been achieving

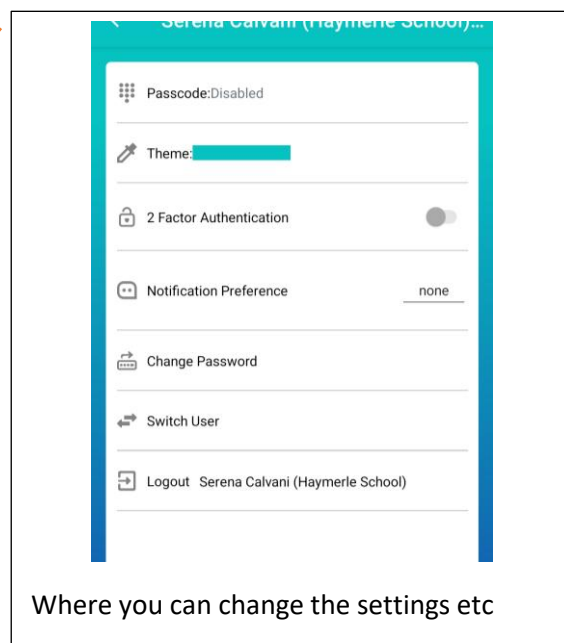
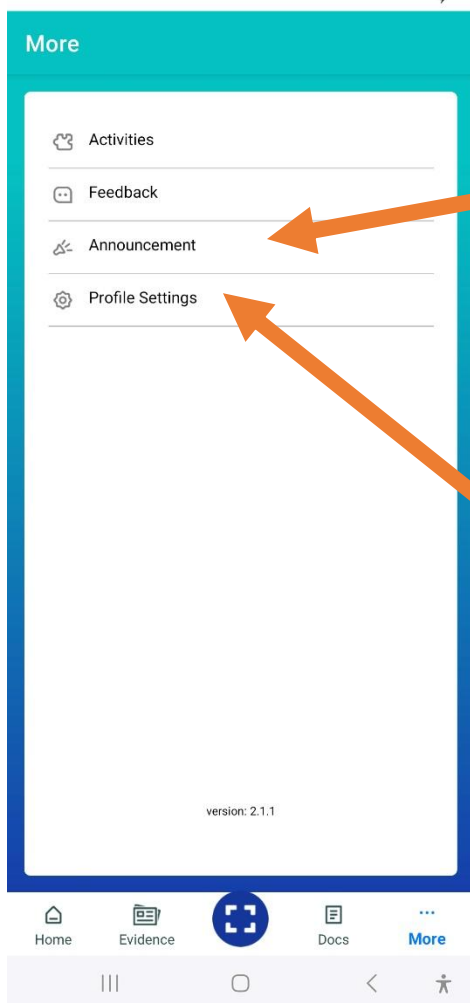

**We appreciate there is a lot of information on these sheets but please do ask you class team for any support that you need in access this or pop in to school to ask a member of staff to support.**

**We hope you enjoy using the app and seeing all the progress that your child is making as well as sharing things that they enjoy doing at home with us too!**