

2 Teaching Block
GA(10)201 1 : 100

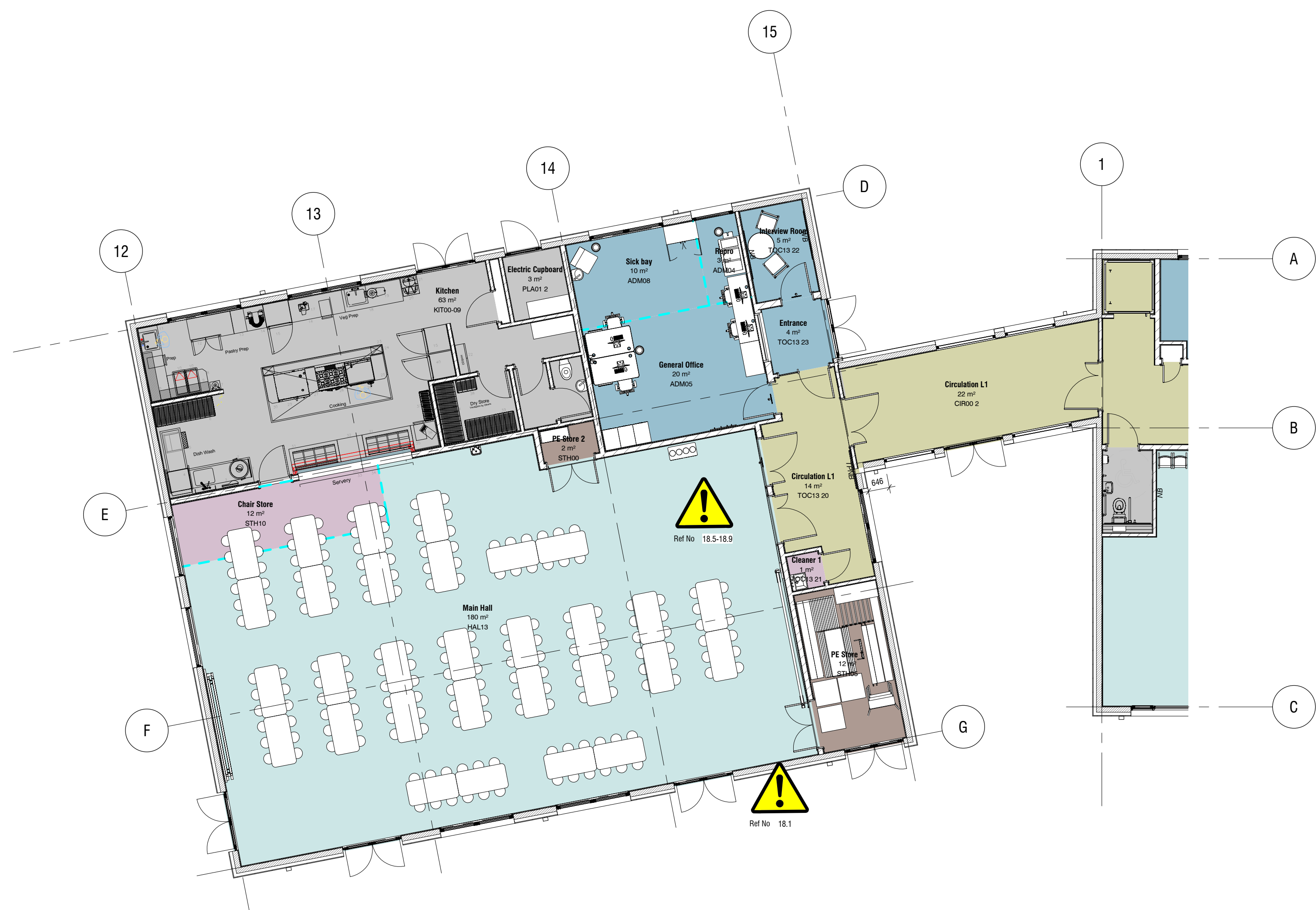

1 Hall Block
GA(10)201 1 : 100

Residual Hazards and Risk
(Refer to COM Hazard and Risk Assessment for full details)

Ref 3.1: Pedestrians have right of way close to or adjacent to the site - risk of injury from debris or falling objects from site
Ref 3.5: Construction traffic may cause injury/disruption due to location of access from public highway
Ref 3.7: Possible clashes between school construction and adjacent residential construction work
Ref 4.5: Location of structures or below ground services means excavating close to existing live services
Ref 6.2: Risk of falling into pond
Ref 6.14: Excavations filled with groundwater will cause unstable ground
Ref 9.2: Installation of components weighing more than 20kg can result in injury
Ref 9.4: Risk of collapse or failure of temporary works that support the pre-cast stairs
Ref 10.3: Risk of falling from roof during construction or maintenance
Ref 10.5: Risk of falling from parts of roof that are not 'man-safe'
Ref 11.1: Components weighing more than 20kg - risk of injury during installation of SIPs
Ref 11.2: Large prefabricated units such as prefab toilet pods, SIPs & stairs - risk of collapse
Ref 16.1: Risk of falling - working at height
Ref 16.8: Cables - risk of collapse
Ref 18.1: Risk of injury from on-site cutting of brickwork
Ref 18.5-18.9: Risk of inhaling toxic chemicals

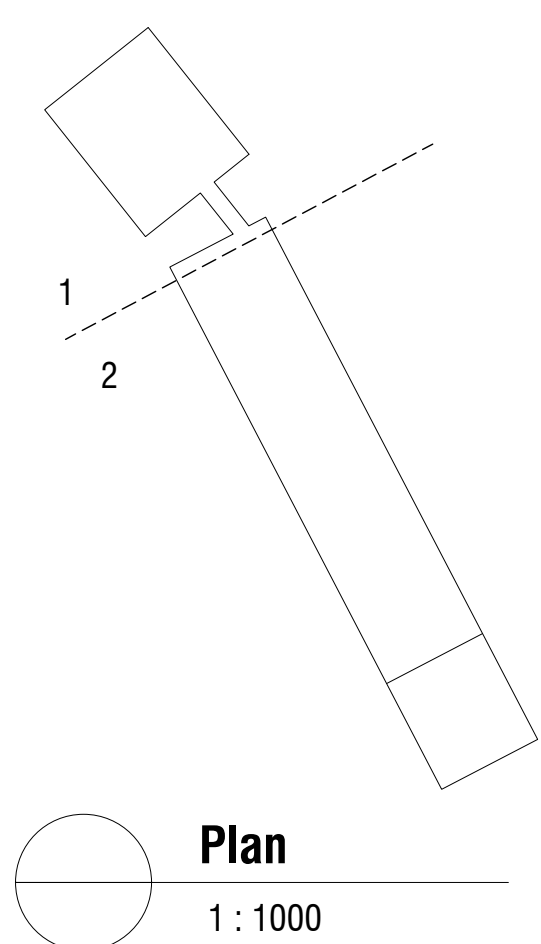

Plan
1 : 1000

- Department Legend**
- Circulation
 - Large spaces
 - Non-net Area
 - Non-Teaching Storage
 - Staff and Administration Areas
 - Storage

Note:
Coordination with Innovare's layout required

ER 6	Walls updated	10.08.17	ER
ER 5	Construction - first issue	24.07.17	JH
4	Updates to CPs	26.06.17	ER
JH 3	Contractor's Proposals	27.03.17	ER
Revision	Description	Date	Drawn

SCOTT
BROWNRIGG

Client's Name
Galliford Try

Job Title
Kingsteignton School - Exeter

Drawing Title
Ground Floor Plan

Scale
As indicated @ A1

Drawing Number
16893

Drawing No
GA(10)201

Status
Construction