

Dear Parents,

Site Developments

As we have mentioned in previous newsletters, we are excited about the proposed developments to our school site. You will be aware that we have recently been vacating Whittle and King blocks in order to enable building works that provide the appropriate accommodation for the future growth in pupil numbers. Our continued success and excellent reputation is coupled with an increase in birth rates and significant housing developments in the catchment area. This has resulted in a continued trend of being oversubscribed.

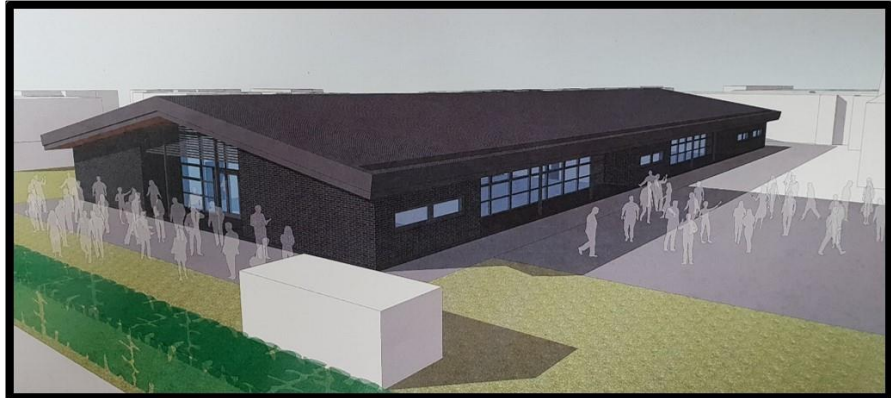

We are going to demolish two of the existing main school buildings, our former Humanities space (King Block) as well as the Technology Rooms (Whittle Block) and build a replacement single storey Design and Technology building, with increased toilet provision.

We are also remodelling other areas of the school, including a new Business and Computing Faculty as well as new Music spaces which will create a fantastic base for our Performing Arts faculty.

Other areas are being moved around in order to ensure that subjects are suited together and students have the very best experience possible. Some of these moves have started, Humanities into Holmes and MFL into Newton, whilst others are reliant upon building work completion.



Having received feedback from site investigations, we are going to have to start some of the preparatory work before the end of term so that we can carry out most of the noisy and disruptive aspects of the work such as the demolitions during the summer holidays and limit as best we can the disturbance to students and staff.

I want to be open and transparent and let you know that part of this work will include removing asbestos which has been identified in the buildings

due to be demolished. Please be assured this will be carried out using the highest standard of regulatory health and safety working methods including isolating the

buildings. These procedures are rigorous and I want to reassure you that there will be no danger to students, staff, visitors or the workmen involved.

We have recently closed the bike shelter earlier than we had planned, but have created a temporary space for bicycles. The bike shelters will be moved shortly to an accessible area in the front car park so that bikes are secured and covered. This will also have an impact on visitor car parking spaces, which will be temporarily reduced.

As we work closely with the Local Authority and the principal contractors, Engie, we will produce more information for parents and establish an area at the front of school to view the plans of our exciting new area. I will also update parents regularly through our termly newsletters.

Thank you again for the interest shown and I hope you are as excited as we are about the way these changes will benefit the students, both present and future.

Yours sincerely,

A handwritten signature in black ink, appearing to read 'Ray Baker', enclosed within a large, loopy oval flourish.

Ray Baker
Headteacher