



# **Lytham St Annes High School Whole School Return**

## **Managing Excitement, Keeping Safe**

### **September 2020**

# Principles

Get back to school safely and sensibly, without catastrophising the last 4 months.

To do this, we need to ensure:

- The safety of staff
- The safety of students
- Clear systems and procedures that support this
- Shared commitment to reducing stress, managing expectations and managing workload

This will be achieved through:

- A series of controls (expectations, rules)
- Clarity of information
- Strong, simple routines
- Structural change to the day and timetable
- Short term changes to procedures



# Reality: Normal?

- All students back in school
- Most lessons taking place with groups of around 30
- Movement in and around the site
- Opportunities to meet outside at break and lunch
- A full curriculum offer for all students

- Bubbles (not sets)
- Strict seating plans broadly based on alphabetical order
- Not all students will be able to return
- Far greater emphasis on rules, routines and behaviour
- No extracurricular provision
- Staggered, amended and changing school day
- Continually reviewing and changing groupings according to need and guidance

# Main layer of safety:

## Government Hierarchy of Infection Control

- **Minimising contact with individuals who are ill** (parents not sending, isolation zone in school)
- **Improved hygiene** (Hand washing available, designated toilets, hand sanitiser available, rota for access to facilities)
- **Good respiratory hygiene** (signs, bin collection between lesson, tissues available, all rooms to have open windows, teacher option of using outside)
- **Cleaning frequently touched surfaces** (cleaners on site, doors open)
- **Minimising contact** (seating plans, teacher space marked out, no work books to be shared, use of student “bubbles” where possible, removed staff social spaces, areas for lunch)



# What are the arrangements for the start of the year?

- Year 7 will start school on **THURSDAY 3<sup>rd</sup> September**
- Year 7 and 11 will be in school on **FRIDAY 4<sup>th</sup> September** (Nb. Year 11 will start at 9:40am)
- School reopens to **ALL** students on **MONDAY 7<sup>th</sup> September** at 8:40am



• How will students be grouped? How will the school implement “bubbles?”



• What are the expectations around school uniform?

• Will we still be using school bags?



• What are the rules on mobiles phones?

• Will there still be provision before and after school?



# What will food and catering look like in September?

**No food before school**

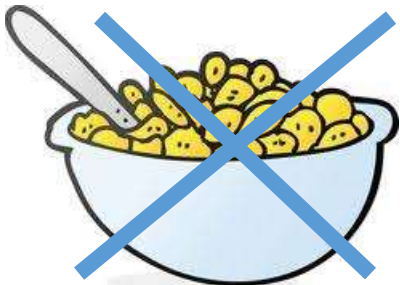

**No food at break**



**Limited offer at lunch**



- How will students get to and from school?
- How will the start of the day work?
- How will the school timetable work in September?

### Emergency Times (September)

	Year 7	Year 8	Year 9	Year 10	Year 11
	Students arrive: All period 1 teachers in classrooms from 8:20am				
8:40	Period 1				
9:40	Period 2				
10:40	Tutor Time	Tutor Time	Break	Tutor Time	Break
11:00	Break	Tutor Time	Tutor Time	Tutor Time	Tutor Time
11:15	Tutor Time	Break	Tutor Time	Break	Tutor Time
11:30	Period 3				
12:30	Lunch	Period 4 (pt1)	Period 4 (pt1)	Period 4 (pt1)	Period 4 (pt1)
13:00	Period 4 (pt1)	Period 4 (pt2)	Lunch	Period 4 (pt2)	Lunch
13:30	Period 4 (pt2)	Lunch	Period 4 (pt2)	Lunch	Period 4 (pt2)
14:00	Period 5				
	Dismissed at 14:30	Dismissed at 14:40	Dismissed at 14:50	Dismissed at 14:55	Dismissed at 15:00



- **What will lessons look like?**
- How are students expected to behave?
- **Will there be any changes related to Covid19 Related behaviour/laws?**
- How will changeover between lessons work?
- **Will there still be provision before and after school?**

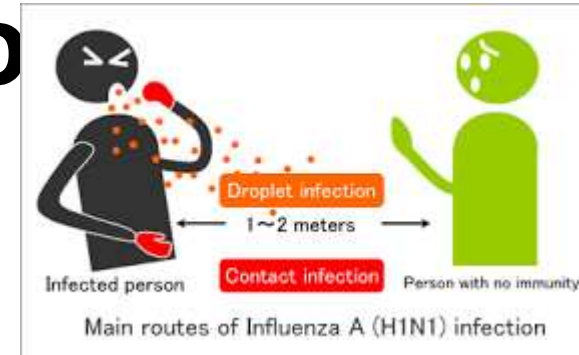

# How will break and lunch work with large numbers on site?

- Split breaks, split lunch
- The school will be divided into two areas/zones. They are shown on this map as blue and green.
- During break and lunch:
  - Year 7 will have access to both Blue and Green areas
  - Year 8 will have access to: Green
  - Year 9 will have access to: Green
  - Year 10 will have access to: Blue
  - Year 11 will have access to: Blue

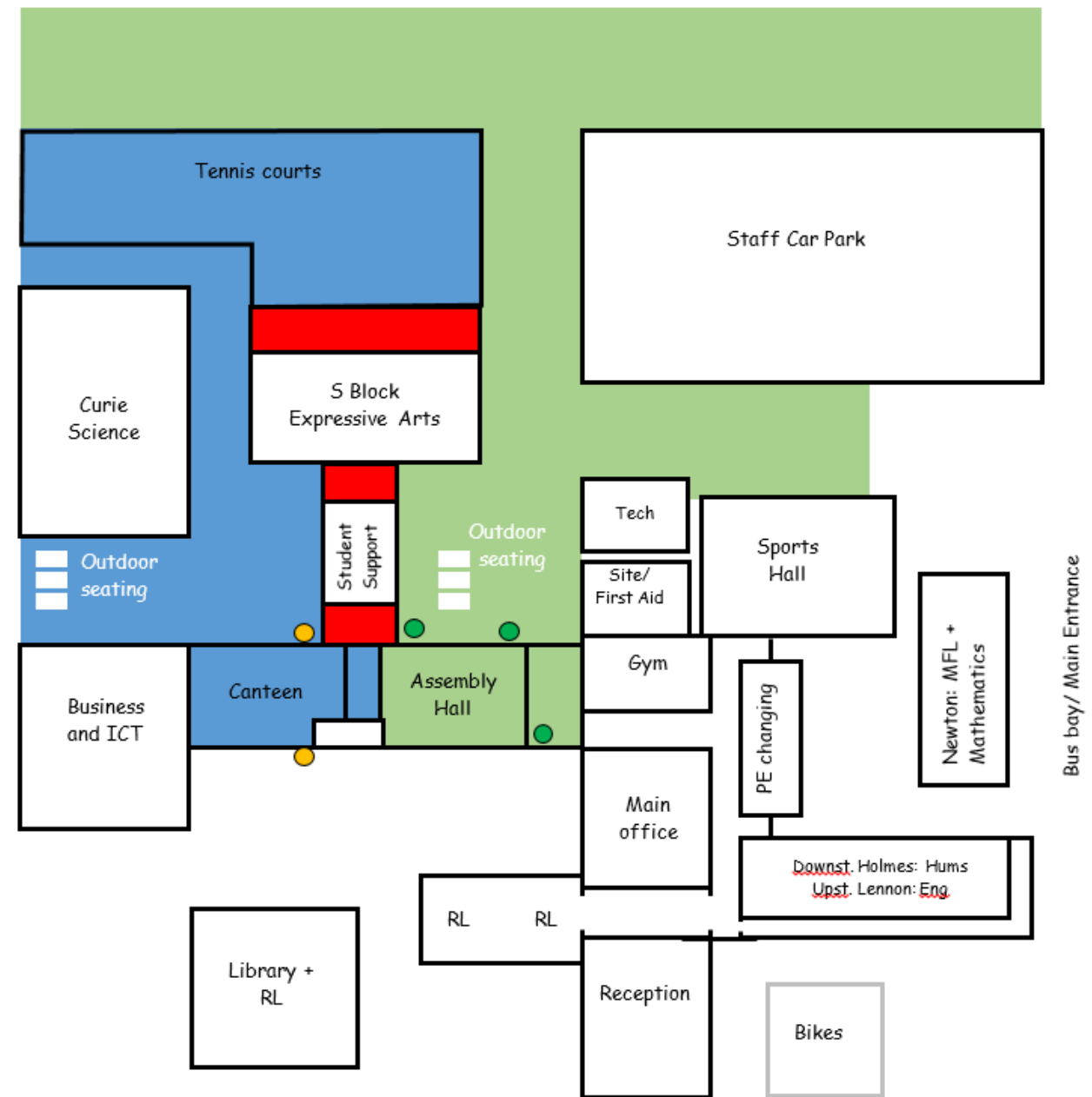

# End of the Day

- We will be managing the dismissal of students in a staggered and controlled fashion, as this is a significant point of contact at a particular time.
- For the first few weeks, students will be dismissed from site at the following times:
  - Year 7: 2:30pm
  - Year 8: 2:40pm
  - Year 9: 2:50pm
  - Year 10: 2:55pm
  - Year 11: 3:00pm
- We are currently working with bus companies to manage their timetables. However, we would ask that student do NOT use the bus stops closest to school. This will lead to large numbers gathering, across bubbles. It will also create pinch points on the bus.
- Please work with your child to leave the site and walk towards a stop further away from the school. This will naturally disperse the large numbers accessing the bus at any one point.

# What will the First Aid/ Track and Trace procedures be?

- Any sign of Covid 19 and you **MUST NOT** attend
- Higher grade PPE for first aid staff
- If your child is sent home you must engage with Track and Trace procedures
- Where a student displays other symptoms in school (i.e. sickness) they will be assessed and managed as per our normal procedures.



- Care plans
- Attendance
- Cleaning
- Facemasks



- **How will we keep in contact between now and September?**
- School is closed for the summer from Friday 17<sup>th</sup> July.
- We will aim to send an update email to parents on each Friday of the holiday period.
- We will also create an area for us to answer any concerns or questions that you may have.

***We also realise that this amount of change is difficult for everyone. We will therefore review processes and procedures every other week, with a view of improving and developing further.***



[www.lythamhigh.lancs.sch.uk](http://www.lythamhigh.lancs.sch.uk)



[lythamhigh](https://twitter.com/lythamhigh)



[LSAHighSchool](https://www.facebook.com/LSAHighSchool)

THANK  
YOU!