

The Case of the Missing Stormtrooper



Mr. Clark is devastated, his Stormtrooper has been stolen!

Ms Kennaugh puts a call out to all Newbridge pupils and their friends to search for Mr. Clark's Stormtrooper and find out who stole it.

Can you help?



The route is just under 3 miles long and should take 2 hours.

Good luck detectives.

The Locations

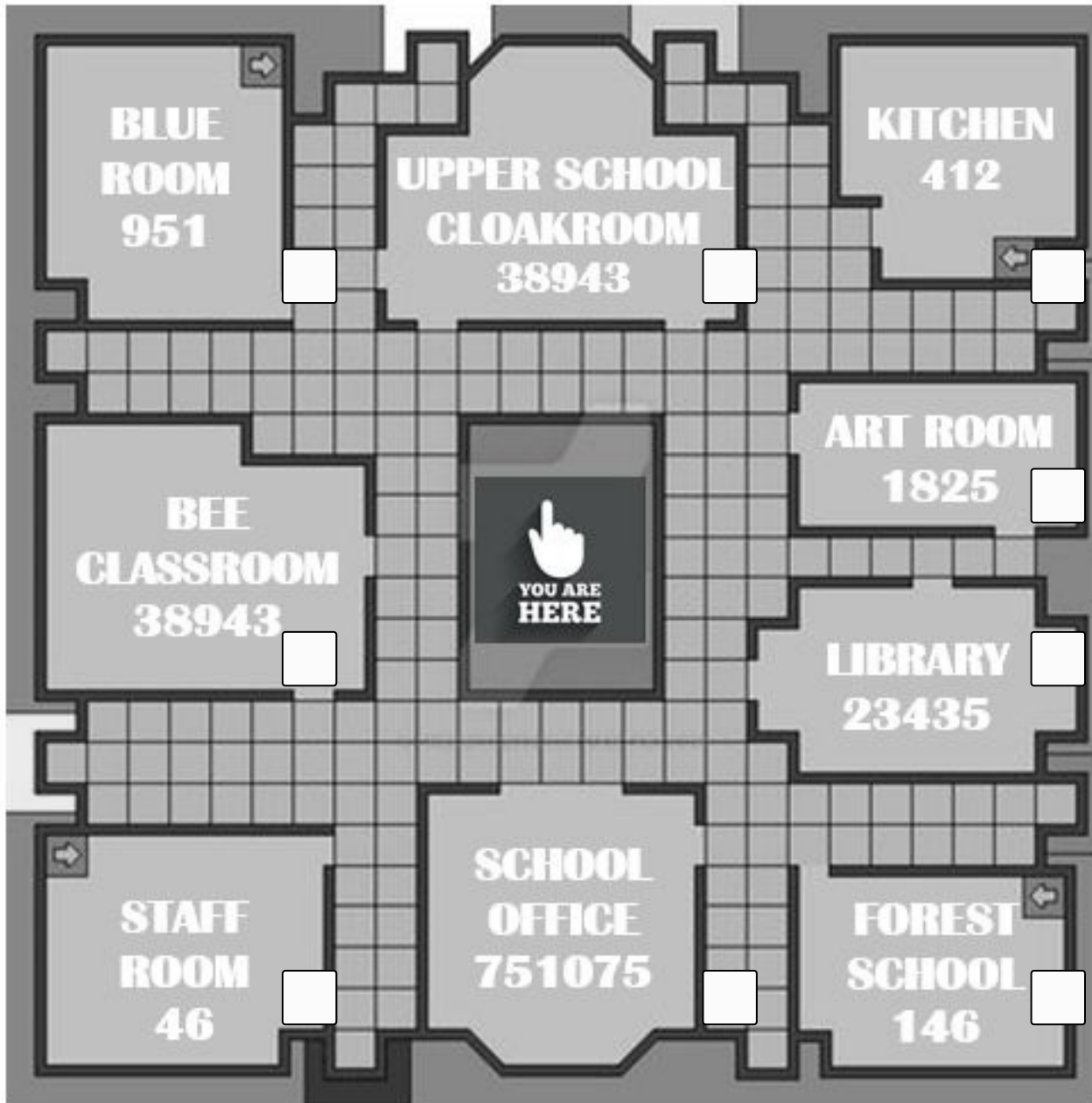

You will need your brain, a pen, paper and the suspect and location sheets.

Follow the link to the google form on a mobile device.

Let the google form guide you along the trail and help you answer the questions to uncover the identity of the thief and the room where the Stormtrooper can be found.

Remain focused at all times. You will need your wits about you to "stay on target".

May the force be with you detectives!

The Suspects

7'0"

7'0"

6'8"

6'8"

6'6"

6'6"

6'4"

6'4"

6'2"

6'2"

6'0"

6'0"

5'8"

5'8"

5'6"

5'6"

5'4"

5'4"

5'2"

5'2"

5'0"

5'0"

4'8"

4'8"

4'6"

4'6"

4'4"

4'4"



POLICE DEPARTMENT
Mrs. Bartlett



POLICE DEPARTMENT
Miss. Gatton



POLICE DEPARTMENT
Mr. Baigent



POLICE DEPARTMENT
Mrs. Clark



POLICE DEPARTMENT
Mrs. Button



POLICE DEPARTMENT
Mr. Day



POLICE DEPARTMENT
Miss. Mylan



POLICE DEPARTMENT
Mr. Bacon



POLICE DEPARTMENT
Mrs. Auld



POLICE DEPARTMENT
Mrs. Hill



POLICE DEPARTMENT
Mr. Hempleman



POLICE DEPARTMENT
Mrs. Amor