

NO DIMENSIONS TO BE SCALED FROM THIS DRAWING  
CDM - RESIDUAL HAZARDS The following are considered to be significant risks relevant to this drawing, which could not be fully mitigated or removed through design:

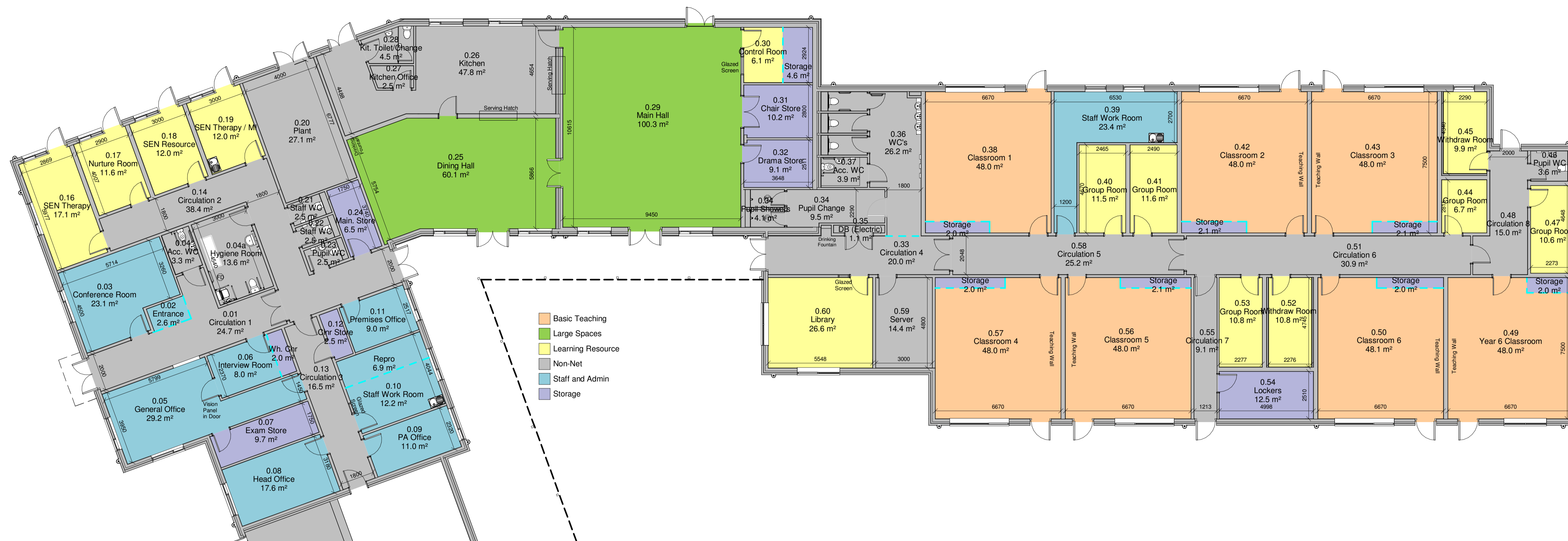

- Basic Teaching
- Large Spaces
- Learning Resource
- Non-Net
- Staff and Admin
- Storage

# 1 00(Ground) - Proposed Ground Floor NTS

P02	Client Changes	29-04-19	AKC	DPT
P01	ITT Gateway 2 Submission	18-03-19	FEW	AKC
Revision	Date	Drn	Chk	
This document references the following files:-				
Reference Name	Status	Revision		
142612-B1-ZZ-N3-A-0002	SO	PO1.1		

Client  
**Morgan Sindall**

Project  
**Ramsden Hall Academy**

Drawing Title  
**Plan-GA-00(Ground) Teaching Plan  
General Arrangement Plan  
Ground Floor**

Suitability Status  
**S4 - Suitable for Stage Approval**

Job No.	Scale	Size	Rev
190002	NTS	@ A1	P02

Drawing Number  
**142612-PEV-B1-00-DR-A-1202**

Client Code Originator Zone Level Type Role Number

