

OPEN EVENING

Wednesday, 29th September 2021



Welcome and Subject Guide

Guides, prefects and staff will be available
to help direct you around school

Welcome to

St Mary's Catholic High School, Leyland

I am delighted to welcome you to our Open Evening here at St Mary's Catholic High School. We are a school that continues to thrive and build on the successes of recent years. At St Mary's, we unashamedly set high standards and expect the very best of our pupils. In so doing, every child is given the opportunity to flourish and fulfil their God-given potential.

Our Open Evening will allow you to experience activities in every department. Please feel free to ask questions of both staff and pupils alike. We want you to leave tonight with as full a picture as possible of what life is like at St Mary's.

We have a calm and purposeful working environment, within modern and well-equipped buildings, and a rich extra-curricular provision. All of this combines to allow pupils the opportunity to excel. They are wonderfully supported by staff who are hard-working, caring and committed. In short, we are a community where all members are valued and respected.

The inspiration for all we do comes from our Catholic faith and is based on the Gospel values of love, honesty, respect and forgiveness. In so doing, we believe our Mission, which is to 'Let Your Light Shine', comes alive, allowing pupils to feel safe and have the confidence to develop their talents.

Thank you for considering St Mary's Catholic High School for your child's education. I hope tonight gives you an insight into why we are so proud of our school and the work we do here. In addition to our Open Evening, any parents considering St Mary's are more than welcome to book an appointment and visit us at any time, we would be delighted for you to see the school in action.

Phil Thompson
Headteacher

Chaplaincy

Chaplaincy plays an important role here at St Mary's, providing spiritual support and guidance, supporting the outstanding pastoral team, and working in unity with the RS faculty. The purpose of Chaplaincy is to support staff and students, who form the school family, through encouragement, friendship, prayer and a listening ear. Students at St Marys' have a variety of opportunities to explore what it means to be of faith, with a strong emphasis on exploring what it means to put faith into action.

Through words, actions and relationships the whole school community is nurtured in its response to God's call and challenged to celebrate it joyfully in life and liturgy.

We believe that school is a holy place because Christ is at the heart of all we do and are and strive for here at St Mary's. Our belief that God has created every person shapes our attitude to all, so that we recognise each person has been created with a purpose, is valuable and has gifts and talents, which they can use in everyday life. As well as teaching the Catholic faith and values through the curriculum, we also strive to help students grow spiritually and foster in them the realisation that they are loved by God. Through our school Masses, assemblies, collective worship, services of Reconciliation, retreat and pilgrimage programs and other liturgies, we come together as a school family. These experiences serve to remind us all of our duty to care for others as members of the Body of Christ in the world today.



Religious Studies

Rooms 4 to 6 and Chapel

The report from the Commission on Religious Education in September 2018 stated “RE should be enacted to ensure that learning in this area remains academically rigorous and a knowledge rich preparation for life in a world of great religion and belief diversity.”

Taught by five teachers, Religious Studies at St Mary’s will teach your child the necessary skills for academic success, and prepare them for life beyond school.

At KS3, pupils follow the Liverpool Diocesan programme of ‘People of God; Called to Serve’; firmly exploring Catholic beliefs and practices; along with related life issues. Pupils are also given an opportunity in each year to study a World Religion; adding depth and diversity to their knowledge. All of which are essential in the changing world in which we live.

At KS4, pupils follow the AQA B GCSE course of Catholic Christianity; along with Judaism and two ethical themes. This syllabus provides a greater depth of knowledge and more rigour for every pupil.

Religious Studies is at the heart of the curriculum at St Mary’s, providing a foundation for your child’s future. Many skills are gained through Religious Studies, challenging your child to apply their knowledge; remember key facts; apply their beliefs to everyday life situations and have the ability to evaluate contrasting views. Religious



Studies addresses fundamental human questions and allows discourse to occur. In providing these opportunities in Religious Studies, your child will have the ability to think deeply about complex issues, and inspire them to live out the Gospel values both in and out of school.

English

Rooms 101 to 106

Welcome to the English department where a well-lit path to a varied and engaging curriculum awaits you, regardless of ability. You will study aspects of both popular and high culture in your lessons, and work towards two GCSEs: English Language and English Literature. These are now graded from 0-9 with 4 being considered a standard pass rate. There is no course work and pupils will sit two exams in language: 19th and 21st century non-fiction and 20th century fiction with creative writing. They will also sit two exams in literature which will focus on pre and post 19th century literature, poetry and Shakespeare. The KS3 course closely links with the KS4 specification to fully prepare pupils for the path ahead.



English Language is used in a variety of ways, such as informal and formal conversations, advertising material, texts and tweets, and legal and medical discourse. Your English curriculum provides engaging lessons that promote the evolution of the English language. You learn about everything from the smallest phoneme to the most complex aspects of grammar and tone.

English Literature helps you discover features of language and technical devices and learn how they can be used for specific and aesthetic purposes. Your programme of study includes: poetry; the use of beat, metre and rhythm. Novels, plays and short stories and how they can help improve your own writing. We encourage and inspire you to 'lose' yourself in a book because literature is an 'antidote' for all you will experience in your life.

Set texts that we study at KS4 are: A Christmas Carol, Dr Jekyll and Mr Hyde, Blood Brothers, An Inspector Calls and Romeo & Juliet.

We have a number of clubs that you can join:

LSM Post – this a journalist group that runs the school newsletter and this is sent out with our main newsletter and is produced by pupils and about their school life.

Drama group for year 7 and 8 for all those aspiring actors and performers each Monday after school.

Creative writing club – to help all future novelists or aspiring creative writers; we enter many competitions throughout the year.

English Homework: We like to be creative with our homework and give our pupils an element of choice in what they want to complete each week and this is based around a differentiated Nando's style take-away menu. They range from extra mild to extra hot and these suits all of the needs of our young people, regardless of their ability.

Mathematics

Rooms 3 & 109—113

Imagine trying to cope in the 21st century with no maths skills. From telling the time and working out change, to designing the next new roller-coaster or calculating the trajectory of a space shuttle – maths is intrinsic to all facets of life. The speed at which technology is developing, shows that our youngsters will need that number knowledge and problem solving skills if they are to succeed. The jobs that they will aspire to do probably don't even exist yet and we at St Mary's need to prepare them for that.

During Years 7 to 9, pupils follow a maths curriculum that will support them whatever their starting point. During those valuable three years they will not only develop and build a solid numerical foundation started in primary school, but also come to appreciate where that knowledge fits in the wider world, be it in working out the best deal at the supermarket or how the Egyptians armed only with a piece of string created exact right angles. We will help pupils to understand that their unique approach to solving a problem is not wrong and foster an environment in which they are willing to attempt a question, even though they are not quite sure and that in turn will develop their confidence and resilience to attempt questions that aren't quite as straightforward as those they've dealt with in the past.

In Years 10 and 11, all pupils will study for their GCSE Mathematics qualification. They will be split according to their results and abilities and study either the Edexcel Foundation or Higher programme of study. They will continue to develop their problem solving ability to help them find solutions to not only maths questions but will also learn to transfer those skills to solve numerical based questions in other subjects. The final exam will consist of three 1½ hour papers, equally weighted, with Paper 1 covering only non calculator skills.

Homework for all years is set using a mixture of worksheets, research, independent study and online using MathsWatch. Help and support will always be given if needed. If you have any further questions, please don't hesitate to speak to a member of the maths team.



Science

Rooms 12S to 17S

All science students at St Mary's Catholic High School Leyland experience a rich and balanced diet of study in both Key Stage 3 and Key Stage 4. In our school we have seven state of the art laboratories, each fully equipped with gas, water and electricity to allow access to all three science areas. Each lab also has an interactive whiteboard and Wi-Fi to allow the latest technology to be utilised. The department makes full use of the excellent resources and practical lessons feature highly throughout the curriculum.



We believe that engaging young people through active science education develops inquisitive minds and fosters a love of science and an appreciation of science in the world around us.

At GCSE we offer two pathways through Science. The first is Combined Science where students study for two Science GCSE's over the two and a half year program. Most students complete this programme of study, providing them with an excellent foundation in science for further educational choices such as apprenticeships and academic study including A-levels. Alternatively, if our students have a very keen interest in science and aspire to complete further scientific qualifications such as A-Levels and a BSc university degree, we offer Separate Sciences which is an ideal choice



for pupils aiming to enter any scientific based career. This course also runs over two and a half years and the student is awarded separate GCSEs in Biology, Chemistry and Physics.

Art & Design

Room 20T

Our well established Art Department is a vibrant part of St Mary's Catholic High School. We pride ourselves on making Art meaningful, enjoyable and accessible to all students.



Art lessons are creative, practical and engaging. The schemes of work are designed to complement the students' practical work and independent learning, in order to encourage creative thinking, self-expression, and problem solving. We recognise the importance of adopting a pupil centred approach to teaching and learning and we ensure that skills learnt in Art and Design are transferable across other curriculum areas.

Key stage 3 Art is carefully planned to support children who wish to continue their Art education at GCSE level and beyond. The department is led by Mrs Edwards who has a strong subject knowledge and breadth of experience.

GCSE Art and Design is a very popular subject. We currently offer the AQA 'Fine Art' syllabus which allows children to fully explore a range of techniques and interests.

The Art department runs regular Art clubs, competitions and exhibits children's artwork at every opportunity in school or in the wider community.



Computer Science

Room 7i

"Our aim is to equip our learners with the skills to live and work both competently and safely in the digital world"



Pupils have access to a wide range of digital learning resources aiding the quality of teaching and learning throughout school. They are given access to Office 365 providing a personal email account, cloud storage and online applications for those who perhaps do not have standard software on their personal devices at home. The use of Office 365 develops digital literacy skills, but also bridges the gap between home/school learning as it allows for resources and project work to be shared between pupil and teacher. The school ensures that there is also a provision and opportunity for pupils to access IT resources should they not have facilities at home.

In Years 7-9 the computing curriculum is delivered in two ways:

Computer Science lessons cover theory and technical aspects of computing such as how computers work, binary representation, networks, algorithms, databases and spreadsheets. Pupils are introduced to block programming before progressing to high level programming languages such as Python in preparation for GCSEs.

Creative iMedia lessons form part of the technology carousel and focus more on the digital literacy and creative media aspects of the subject. Topics include sound recording, animation, video production, graphics and website development. An underlying theme throughout all units of work is digital safety.

At Key Stage 4 pupils can choose to further study the subject. Options include:

GCSE Computer Science: In a digital world the skills acquired within this topic provide an excellent grounding for further education or employment. Pupils learn the theory of computers systems and how they work. Practically, pupils will become confident programmers and are required to design, develop, test and evaluate their programmed solutions for a range of given scenarios.

Cambridge National in Creative iMedia: Whilst media production is one of the main skills which you will develop, the course also allows learners to develop in other areas e.g. problem solving and thinking creatively, innovatively, analytically, logically and critically. These are all desirable skills which today's employers are looking for!

Technology

Room 21T

Design and Technology is an inspiring, rigorous and practical subject which prepares all young people to live and work in the designed and made world. At St Mary's we are very proud of our 'state of the art' facilities that offer all our students access to the very best teaching and learning resources.

Design and Technology builds on the skills and knowledge students have already learnt at primary school. As students' progress through Key Stage 3, they are given the opportunity to focus on specific aspects of the subject and produce a range of products which they have designed, developed and produced themselves, using a range of specialist software, tools and machinery.

All students are encouraged to work independently in a variety of contexts. Each subject offers unique challenges that encourage individual, peer, team and whole class participation whilst having an awareness of safety for themselves and others. Students enjoy practical lessons that encourage participation and gain a satisfaction in producing their own unique product. Students develop a confidence with tools and equipment and share new skills with others while continually applying their ever growing knowledge. Key skills help to develop a growing confidence in problem solving, researching and evaluating in preparation for students choosing to opt for a GCSE in Design Technology during Year 9.



Engineering

Room 22T

“Our aim is to provide students with the skills and experience to set them apart from their peers when applying for engineering apprenticeships or further learning.”



Pupils who study engineering are given the opportunity to develop a number of skills that are sought after in engineering apprenticeships. The main focus of engineering at St. Mary's is to give the students basic practical skills and opportunities to familiarise themselves with machinery they might normally not use. Students will also gain experience in using industry standard CAD (computer aided design) software, along with experience in using CNC machines. Learning is hands on with students completing practical projects that will develop skills such as reading for information, producing working drawings, use of workshop tools and machinery (including the Boxford lathes), health and safety and also using CAD (computer aided design) to design and create parts.

Key Stage 3—Engineering- Lessons cover both technical knowledge and practical skills required at key stage 4. Students will design and make their own project from start to finish. This allows students to become independent problem solvers who will be able to assess a problem and then design and manufacture a possible solution. Students will gain skills in the use of CAD and CAM software as well as learn how to read working drawings allowing them to manufacture their designs. Students will also gain technical knowledge in materials and processes used in engineering. Overall, this is mainly a practical subject where students gain a vital insight into engineering, thus enabling them to make an informed option choice in Year 9.

Key Stage 4—Engineering manufacture—In this subject students will complete a coursework portfolio that will document their ability in both technical knowledge and skill. Students will cover units that allow them to use machinery and software in preparation for employment or further education. Students will develop their practical skills from the outset in using our centre lathes, along with other machines to make the parts needed for an overall product. Students will gain knowledge in materials, processes and types of manufacture. Students will also gain experience of using industry standard CAD software to produce rendered images, as well as create drawings that they can manufacture from.

Food & Nutrition

Rooms 26T & 27T

Food and Nutrition is taught throughout both key stages. Our pupils enjoy and succeed in this subject, with our GCSE students achieving some of the best results in school.

Pupils will be taught the scientific principles behind food and nutrition. They will learn how to use a variety of cooking techniques to prepare and cook food, as well as being able to make informed choices about their own diet.

Throughout KS3 pupils will learn how to cook healthy dishes and develop their culinary skills by acquiring a knowledge of the main commodities: Meat, Fish, Eggs, Milk, Cheese, Bread, Pastry, Fruit and Vegetables. Scientific principles will be investigated to allow pupils to fully understand the functional properties of food. For example; experimenting with the pH levels of food and preventing enzymic browning, to analysing the chemical properties of raising agents.

Throughout KS4, there are 3 assessments to be completed, which will build on pupils' individual strengths. There is a written examination (50% of final GCSE), a food



investigation task (15% of final GCSE) to focus on scientific principles and then a food preparation task (35% of final GCSE) which is a 3 hour practical examination to showcase and demonstrate cookery skills and a variety of techniques that have been learned.

Cross Curricular and Enrichment Activities:

We aim to provide our pupils with additional opportunities to extend their understanding and skills in the subject. Food and MFL often come together to arrange educational visits to Madrid where pupils will encounter a cultural trip of a lifetime, with many tapa tasted whilst practising their spoken Spanish. Vivía España!

Photography

Room 22T

At KS3 pupils will touch on the basics of photography within their technology lessons (particularly iMedia) in which they will be introduced to various images types before moving on to create and edit images using industry standard software such as Adobe

Illustrator and Adobe Photoshop. Should pupils discover an interest or natural talent in the subject, they are able to choose GCSE Photography as one of their option subjects.

The course enables pupils to develop their technical knowledge of photography and use of various equipment e.g. lighting, but also allows them to explore and develop their god given creative talents. They will be given the opportunities to look at a range of photographic styles including; studio, landscape, photo-journalism, documentary and fashion photography to name a but a few.

We have full use of Digital cameras, lighting equipment and the possible use of pupils' phone cameras where appropriate (although pupils do not need to have their own phone to study the course). We have also recently invested in Adobe Cloud Creative which gives pupils access to industry standard software in order to edit and manipulate their work. Given the software is cloud based, this means pupils can access their work both in school and at home.

Assessment is made up of Component 1 which is a portfolio contributing 60% to the mark, and component two which is an externally set assignment and accounts for 40% of the final mark.

Cross Curricular and Enrichment Activities: As a subject there are plenty competitions, we encourage pupils to become involved in, both local and international, and trips out will be available, where possible, to take images for current projects. We also have links with colleges and universities to help with development and future planning.



St Mary's Catholic High School

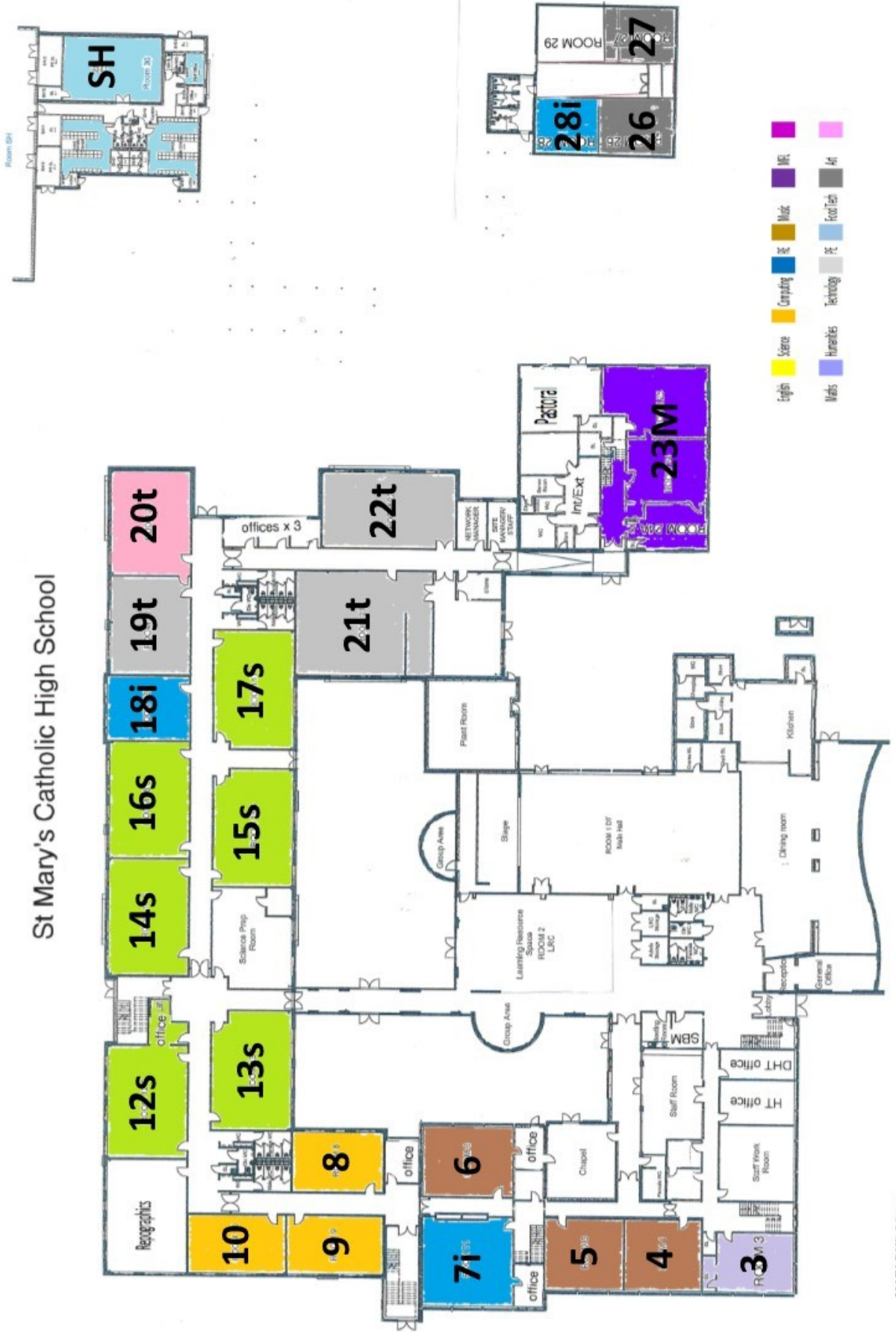

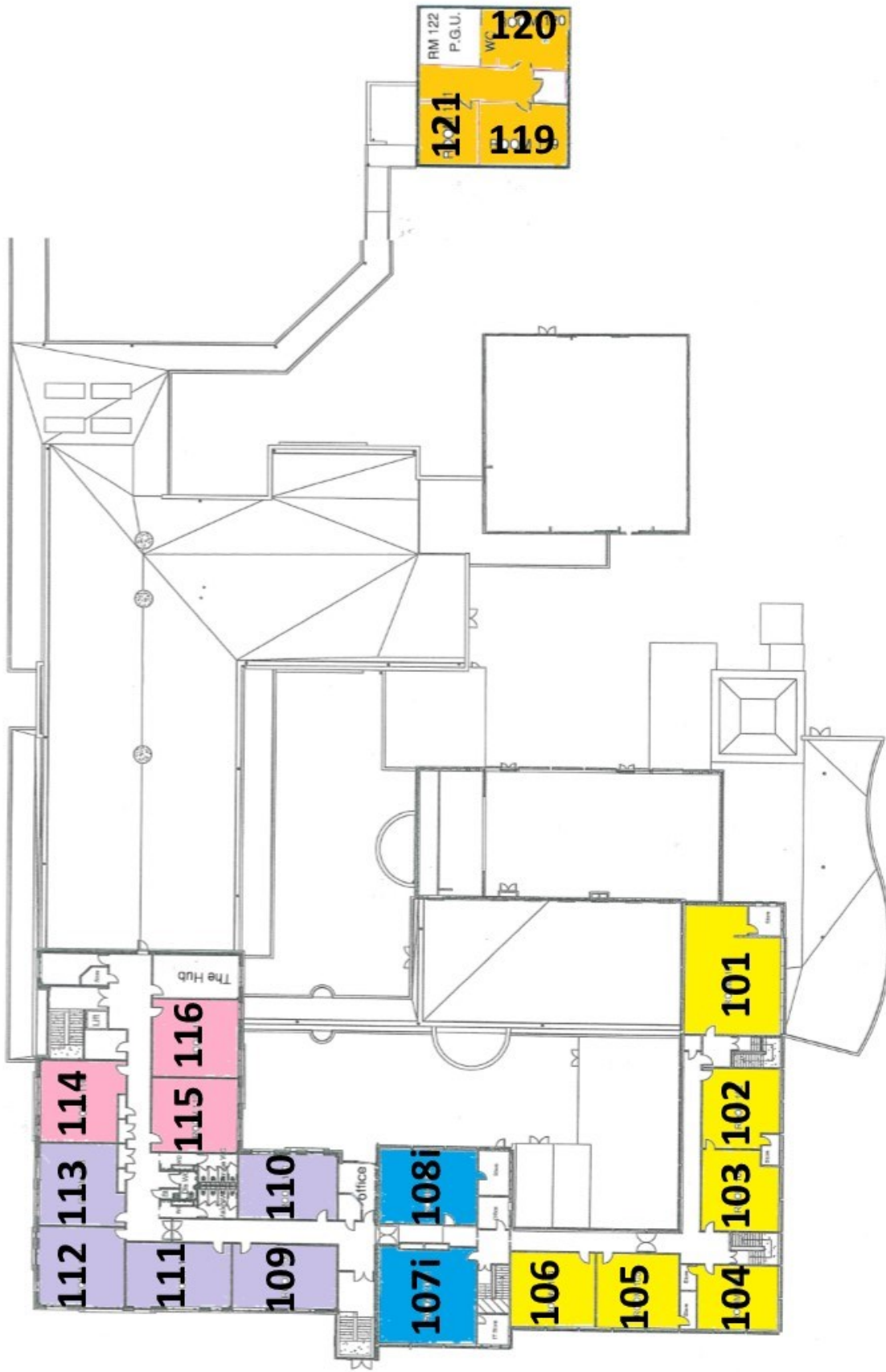

MAIN BUILDING
First Floor Plan

History

Rooms 8 to 10 & 119 to 121

We teach history at St Mary's to engage students to develop a love, passion and desire for the subject. As a history department, the curriculum is structured to encourage resilience and an aspiration in the pupils to *let their light shine* becoming a tolerant independent thinker, who can use their knowledge of the past to understand the issues of the present and how they can shape the future.

Our new Key Stage Three has been developed in such a way as to ensure that learning about the past is a fascinating part of your child's timetable. We have three distinct themes for KS3—'A Changing Britain', 'A Changing World' and 'The 20th Century—a depth study.'

To ensure History is as memorable as possible for pupils we endeavour to challenge pupils outside the classroom by offering exciting homework projects such as: castle building, media production and cake trenches. In class we have a strong focus on academic excellence. We take every opportunity to help all of our pupils to celebrate their successes, whilst building time into the curriculum for reflection and review. This has led to many successful pupils continuing their History studies at A Level and beyond.

At Key Stage 4 we study the Edexcel exam board. This exam syllabus allows pupils to gain a diverse knowledge of history and includes topics such as; Early Elizabethan England, Medicine through time with a focus on the Western Front, Cold War and Germany 1918—1945.

At St Mary's we have excellent facilities and the ability to use a wide range of materials in reaching our goals. History is taught at St Mary's by our experienced team of Humanities teachers.

We feel it is vital that pupils are allowed to see history in action therefore we are excited to offer the following educational visits: The Battlefields of WWI, the Trans—Atlantic Slavery Museum in Liverpool and Auschwitz Concentration Camp.



Geography

Rooms 8 to 10 & 119 to 121

Here at St Mary's Catholic High School, geography is a hugely popular subject situated in its own suite of rooms, and taught by enthusiastic, dedicated and passionate geographers.



Geography builds on young people's own experiences, helping them to formulate questions, develop their intellectual skills and find answers to issues affecting their lives. It introduces them to distinctive investigative tools such as maps, fieldwork and the use of powerful digital communication technologies. It opens their eyes to the beauty and wonder around them and acts as a source of inspiration and creativity. More than this, it ensures that they appreciate the complexity of attitudes and values which shape the way we use and misuse the environment. Through geography, people learn to value and care for the planet and all its inhabitants.

We live in a world of amazing beauty, infinite complexity and rigorous challenge. Geography is the subject which opens the door to this dynamic world and prepares each one of us for the role of global citizen in the 21st century. Through studying geography, people of all ages begin to appreciate how places and landscapes are formed, how people and environments interact, what consequences arise from our everyday decisions, and what a diverse range of cultures and societies exist and interconnect.

Fieldwork is a key component of geography and visits have included locations as far away as Iceland and Italy, as well as some destinations a little closer to home, like the Lake District National Park, Liverpool and the Fylde coast; proving that geography is all around us.



Sociology

Room 10

Sociology is the study of society, but it goes well beyond that. Sociology looks at the social lives of individual people, groups or even collective arrangements in entire societies. It studies our social patterns, especially human behaviours in societal structures and groups. It is interesting, exciting and relevant to students lives.

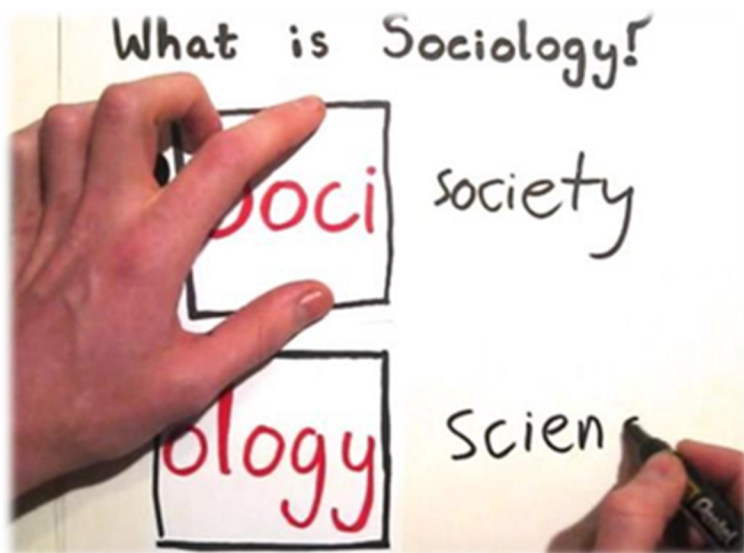

Sociology encourages students to approach social issues from novel and statistical angles thereby developing skills of analytical thinking.

Being a social science, methodology is a key part of sociology. On the course students study the different methods that sociologists use in order to investigate the way society works and why humans do the cultural things that they do.

Academically speaking, sociology is a demanding subject that requires a considerable level of skill and effort. Students must have excellent analytical and reasoning skills as well as a high level of literacy.

The course is divided into seven units, as follows: studying society, research methods, families, education, crime and deviance and social stratification.

Students sit two examinations at the end of Year 11. There is no controlled assessment or coursework and there is no foundation tier; all students sit the higher paper.



Health & Social Care

Room 108i

As of September 2021 St, Mary's have been excited to introduce Health and Social Care as a new Option subject. This qualification introduces students to the biggest employment sector in the UK, which includes elements of the NHS, health care providers and local authority services. It familiarises students with the Health and Social Care sector and the role it plays in the health, well-being and care of individuals across all age ranges in society.



It is a course designed for those students who have an interest in pursuing further education or a career in a health and social setting such as nursing and childcare. The course enables students to develop good communication skills and the ability to work independently as it is predominantly coursework based. Students will also develop transferable skills, in particular communication and aspects of team work.

This course is recognised as the same level and value as any other GCSE by colleges and universities. Following its completion, a student could decide to follow a number of pathways;

- A Levels

- Study of a vocational qualification at Level 3,

- An apprenticeship

- All of which prepares you to enter employment or to move on to Higher Education.

If you are interested in a caring profession, Health and Social Care is for you. As well as the course content, you will take on a wide variety of skills which all employers seek.

Course content:

Human Lifespan Development — In this unit you will study how people grow and develop over the course of their life, from infancy to old age. This includes; physical, intellectual, emotional, and social factors which may affect them.

Services and Values — Care values are important because they enable people who use health and social care services to get the care they need. This unit will give you an understanding of the health and social care service and help you to develop skills required across the sector.

Health and Wellbeing — You will learn how to use this information to design an appropriate plan for improving someone's health and wellbeing, including short and long-term targets. Additionally, you will explore the difficulties an individual may face when trying to make these changes.

Travel & Tourism

Room 9

Travel and tourism is one of the UK's largest sectors, currently employing over 2.5 million people. Have you ever thought about how many different types of tourism there are, and how important the travel and tourism sector is to the UK economy?

Or about the industries within the sector, their varied roles, and how they work together?

Have you considered how technology is changing the way tourists and travellers engage with the sector and its organisations?

Within this subject we travel the world from the classroom, exploring what influences global travel and investigate how organisations work. Pupils will experience this in action with visits to different organisations and attractions.

“But I don't want to be a travel agent...”

The most common myth is that this course is only for those wanting to be a travel agent – that couldn't be further from the truth! In the past students have gone on to either further study (at Conyers or local colleges) or into the world of apprenticeships. Skills developed on the course will allow you to work in the following sectors to name a few:

- Airline Management/Aviation
- Business Management/Administration
- Retail and Commerce
- Customer Service Orientated Roles



Modern Foreign Languages

Rooms 114 to 116

The Modern Foreign Languages department at St Mary's consists of a team of 3 dedicated staff who are passionate about promoting an enthusiasm for language learning and cultural understanding.



We offer Spanish and French in a pleasant environment, with excellent facilities and state of the art resources. Extra support is available at homework club, where teachers and Year 10 MFL ambassadors are on hand to help.

At GCSE we follow the new AQA syllabus in French and Spanish. Pupils who are competent in other foreign languages are supported in gaining further qualifications and in recent years, pupils have achieved GCSE success in Italian, Turkish, Polish, Mandarin and Arabic.

The department regularly runs educational visits to France and Spain. These visits aim to enhance cultural understanding and practise language skills in a real-life context.

The MFL department is proud to promote qualities of tolerance, resilience and independence in a positive learning environment.

'If you talk to a man in a language he understands, that goes to his head. If you talk to him in his own language, that goes to his heart.'

Nelson Mandela



Music

Room 23M

The music department here at St Mary's is vibrant and engaging, challenging all students to develop as performers. We are very fortunate to have outstanding facilities and resources in our new purpose built Music suite, comprising of the main classroom, a performance room and additional practice room. The department takes a practical approach to music making, with all students being provided with the opportunity to learn to play a wide range of instruments including piano, guitar, ukulele and drums, and this in addition to the solo instrumental lessons which are available with Lancashire Music Service, with whom we have very close links. All students are able to learn how technology is utilised in music from Year 7 through workshops and class based activities, and are trained on software including Sibelius.

At GCSE students follow the GCSE Eduqas specification and this is an increasingly popular option. Extracurricular life at St Mary's is designed around the students passions in performance, and to this end we currently have a full school choir, Year 7 choir, rock bands and ukulele club. Opportunities to become involved in Music clubs are open to all and highly encouraged, and suggestions for extra clubs are always welcome and will be accommodated where possible.

Students are given opportunities to perform in school concerts, school productions and band nights. Music is also an integral part of our ethos and students are frequently given the opportunity to contribute musically to masses and services.

If you require further information please contact Mr Watson, our Head of Expressive Arts who will be happy to help.



PHSCEE

Our PSHCEE (Personal, Social, Health, Citizenship and Economic Education) curriculum intends to build pupils confidence and resilience, as well as preparing pupils for their adult lives, teaching them to understand how to engage with society, make good decisions, and become effective citizens who flourish and contribute positively. It directly develops and deepens pupils' understanding of the fundamental British values of democracy, individual liberty, the rule of law and mutual respect and tolerance. In all topics, pupils are encouraged to understand that difference is positive and that individual characteristics make people unique.

Our PSHCEE curriculum provides an inclusive environment which meets the needs of all pupils, through a detailed knowledge and understanding of the pupils we teach and close liaison with the pastoral team. The PSHCEE topics, delivered by identified and specific specialist staff, facilitate the development of pupils' character, encouraging them to reflect wisely, learn eagerly, behave with integrity and cooperate consistently well with others. All lessons end with communication of the relevant support available.

PSHCEE teaches pupils the importance of being physically healthy, eating healthily and maintaining an active lifestyle; pupils come to realise the effect of these things on their personal emotional and mental wellbeing. Pupils' also receive age-appropriate understanding of risk-taking behaviours, the difference between right and wrong, healthy relationships and sex education. They are encouraged to be reflective about their own beliefs (religious or otherwise) and perspective on life and to be aware of and have respect for, different people's faiths, feelings and values.

Our Careers and Money Management topics support our careers programme, encouraging pupils to aspire, make good choices and understand what they need to do to reach and succeed in their careers of choice. Pupils also receive an insight in to salaries, the cost of living and how to manage their money. The link is made between their career of choice, the journey to getting there and their potential income.

The now statutory Relationships and Sex, Education (RSE) element of the PSHCEE curriculum is taught using Ten Ten's new programme, Life to the Full, which teaches RSE within the context of a Christian understanding of human sexuality rooted in the wisdom and teaching of the Catholic Church.

We are especially proud of our PSHCEE curriculum at St Mary's; it extends far beyond the academic, technical and vocational. We support pupils to grow in many diverse aspects of life and we take our responsibility to develop the whole child, very seriously.



Physical Education

In Physical Education we are committed to providing a curriculum that is broad, balanced, challenging and fosters a love of learning. We match our curriculum to the abilities, interests and aspirations of our pupils, to give every child the opportunity to strive for personal excellence. We aim to open doors for every pupil, and we therefore value the contribution that creative, practical and vocational learning brings to a child's development. Our hope is that every child who leaves St Mary's Catholic High School has the skills, knowledge and character to access opportunities and to lead a healthy active lifestyle that fosters positive relationships, resilience and independence.

In order to fulfil these ideals our Curriculum requires pupils to engage with different learning models in sports in KS3 and then provides a more bespoke approach through our 'options routes' at KS4. At KS3 pupils are taught a number of activities throughout the year and are put into single sex or mixed groups, based on their ability. This allows them to make progress, whilst also allowing them to feel comfortable and challenged within their learning environment. At KS4, GCSE PE & Sports Studies pupils are placed together to improve their overall practical grades in a wide range of activities. The focus for pupils who choose not to take one of the alternative pathways in sport will shift from learning a variety of skills to developing a healthy, active lifestyle, preparing our pupils for life post St Mary's.

During extra-curricular activities, pupils are given the opportunity to practise activities at lunchtime and after school, with a variety of activities on offer including: football, netball, table tennis, rugby, handball, basketball and badminton. Pupils can also represent their House in interhouse competitions. School teams are entered in all the South Ribble Schools' tournaments and competitions. Excellent behaviour, pride in appearance and a very committed approach underpins all teams along with fair play and sportsmanship.

At St Mary's, we believe that educational visits form a significant role in the overall development of a young person. Visits provide opportunities to participate in, and benefit from, a range of activities and experiences that serve to extend and consolidate pupils' academic learning as well as promoting their social and emotional development. We offer sports tours every two years with a specific sporting focus. Our next tour embarks in October 2021 on a Netball and Football tour to Villa Real.

PE facilities are outstanding allowing pupils to achieve their potential, in a vibrant and purposeful environment. The Department has a PE based classroom, with ICT facilities that are used for theory based lessons.

St Mary's Sports Leadership Academy is also available here. This is an excellent way for pupils to enhance their leadership skills, encouraging other pupils to take part in sport whilst also completing and achieving National recognition through the YST Lead2Employability programme.



Performing Arts

Performing Arts here at St Marys is a subject which encourages expression, develops confidence and promotes creativity and confidence. Time and time again we see students flourish through the opportunities provided to develop their performance skills and we are incredibly proud of how our students let their light shine.



Performing Arts is taught in our impressive Drama Theatre, and we are fortunate to have a purpose built stage with lighting and sound on which performances can take place. Additionally we have a dance studio with barre and mirrors to allow for group and individual practice. Performing Arts as a subject is currently taught at KS3 and KS4 with students following the BTEC Tech Award in Performing Arts. This course allows students not only to perform but to engage with the design aspect of Performing Arts by focusing on costume, lighting or set design.

Each year we offer a range of enrichment clubs based around the performing arts and put on a variety of performance to allow students to showcase their work and talents.

Please contact Mrs Watson, Curriculum Leader for Expressive Arts for further information.

Special Educational Needs

Pupils with SEND are welcome at St Mary's. We run a very inclusive school and do all we can within the provision we have to accommodate every child's need, whilst ensuring all pupils have the chance to achieve their potential, to enjoy all the curriculum has to offer and to take part in extra-curricular activities.

Our school is a safe and welcoming environment with wide, bright corridors, lift access for those with access needs and disabled toilet facilities. Each day our nurture facility is open for breakfast, break and lunch for KS3 pupils. This area gives pupils the chance to make and grow friendships in a safe, secure and supervised environment whilst enjoying activities such as 'book and brew', film club and Christmas craft club.

Our team of TAs are dedicated and experienced and support many pupils in class or through small group interventions. However, our ultimate goal is make St Mary's pupils independent and successful and this is always at the heart of the support we give. If you require any further information please speak to Mrs Schofield (SEND CO) or a member of the TA team.





SCHOOL ADMISSIONS SECONDARY

SOUTH

Do you have a child starting secondary school
in September 2022 and living in Lancashire?

APPLY NOW!

WWW.LANCASHIRE.GOV.UK/SCHOOLS

or give us a call on 01772 532109

CLOSING DATE: 31 OCTOBER 2021

You must apply even if an older brother or sister is already at the school.

HAVE YOUR SAY

Between 1 October and 31 January schools are consulting with you to make sure admission arrangements meet future needs. To find out more please visit www.lancashire.gov.uk and search 'School Admission Policies'.

www.lancashire.gov.uk/schools



APPLICATION FOR ADMISSION SEPTEMBER 2022

ST MARY'S CATHOLIC HIGH SCHOOL, LEYLAND

St Mary's is a Catholic School under the trusteeship of the Archdiocese of Liverpool. It is maintained by Lancashire County Council. As a Voluntary Aided School, the Governing Body is the Admissions Authority and is responsible for taking decisions on applications for admissions. The co-ordination of admissions arrangements is undertaken by the Local Authority. For the school's year commencing September 2022, the Governing Body has set its admissions number at 166.

Our principal role as a Catholic school is to participate in the mission of the Catholic Church by providing a framework which will help children to grow in their understanding of the Good News and in the practice of their faith. The school will help the children develop fully as human beings and prepare them to undertake their responsibilities as Catholic in society. The school asks all parents applying for a place here to respect this ethos and its importance to the school community. This does not affect the rights of parents who are not of the faith of this school to apply for and be considered for a place here.

ADMISSIONS TO THE SCHOOL will be determined by the Governing Body. Parents must apply online via the website www.lancashire.gov.uk/schools. If you wish to have your admission request considered against that school's faith/denomination criteria then you should **ALSO** complete the Supplementary Information Form (SIF) available in the Local Authority Admissions Booklet or the school's own SIF. All preferences listed will be considered on an equal basis and, where there are more applications than the number of places available, the following set of OVERSUBSCRIPTION CRITERIA will be applied:

You must complete the County Admissions Form online by 31/10/21.

Admission Criteria

1. Looked After Children and previously Looked After Children. This includes children who appear to have been in state care outside of England and ceased to be in state care as result of being adopted.
2. Baptised Catholic children who will have a sibling* in the school at the time of admission
Baptised Catholic children resident in the parishes of St Mary's, Leyland; St Catherine's, Farington; St Agnes', Eccleston; St Mary's, Euxton and SS Peter & Paul, Mawdesley.
4. Other Baptised Catholic children
5. Other children who have a sibling in the school at the time of admission.
6. Children attending one of the following Catholic Feeder Primary Schools in the parishes named in criterion 3 above: St Anne's, Leyland; St Mary's, Leyland; St Catherine's, Farington; St Mary's, Euxton and SS Peter & Paul, Mawdesley.
7. Children from other Christian denominations. Proof of Baptism in the form of a Baptismal Certificate or confirmation in writing that the applicant is a member of their Faith community from an appropriate Minister of Religion is required.
8. Children of other faiths. An appropriate Faith Leader would need to confirm in writing that the applicant is a member of their faith group.
9. Other children.

Where there are more applicants for the available places within a category, then the distance between the Ordnance Survey address points for the school and the home measured in a straight line will be used as the final determining factor, nearer addresses having priority over more distant ones. This address point is within the body of the property and usually located at its centre. Where the cut off point is for addresses within the same building, then the single measure between address points will apply and the Local Authority's system of a random draw will determine which address(es) receive the offer(s). Children with a Statement of Special Educational Needs or Education Health Care Plan that names a school will be offered a place without using the admission criteria and will count as part of the school's published admission number.

**The School Admissions Policy contains more detailed information
regarding applications for places.**



We hope that you have enjoyed your visit to St Mary's. You are most welcome to visit on a normal working day. Although you do not have to make an appointment, should you wish to do so, please contact us on

01772 421909

or via

head@lsmchs.com

www.lsmchs.com

Twitter @LeylandStMarys

Facebook @St MarysLeyland

Closing date for secondary applications for September 2022

31 October 2021