

## Health and Safety

If you see anything, in the fabric of the building, physical environment or surrounding grounds of the school, that you consider *unsafe* or a *risk*; please report this to the school office or a member of the Safeguarding Team immediately .

## In the event of a fire or alarm:

Please leave the school via a fire exit and gather at one of the

### Fire Assembly Points.

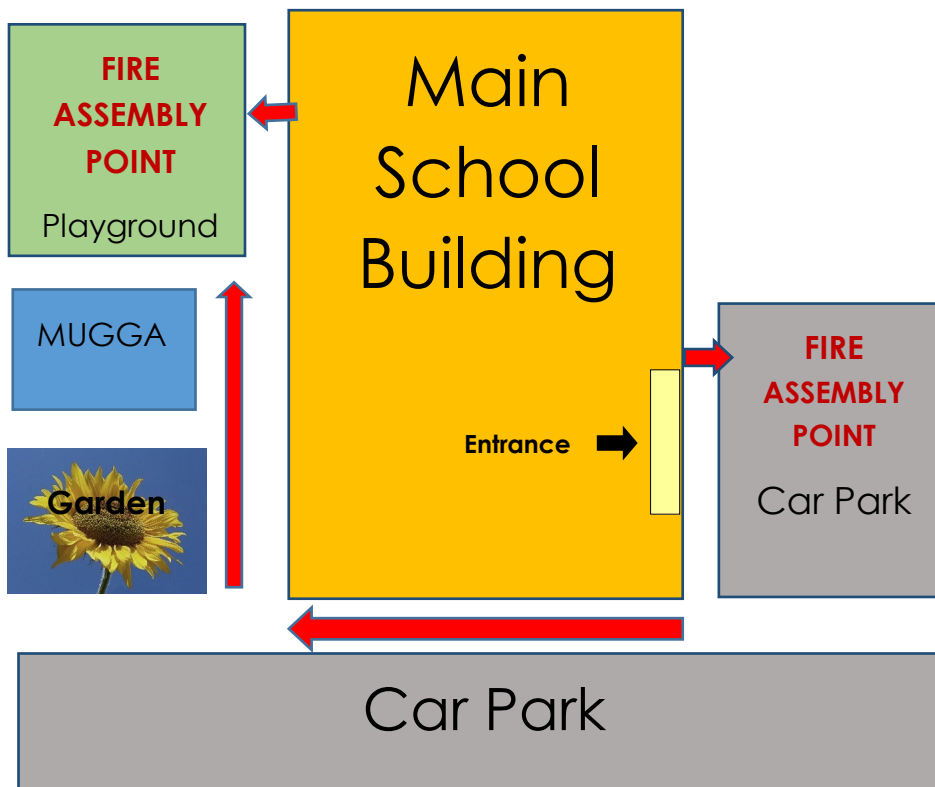

## Guidelines for visitors

At St Nicholas School we work together to ensure our pupils are kept safe at all times.

If you think a pupil is in need because they are suffering or likely to suffer significant harm; you must speak to one of our Designated Safeguarding Leads.

## Designated Safeguarding Team

Stephen King	Deputy Headteacher (Lead DSL)
Richard Dalton	Headteacher
Lorna Sullivan	Assistant Headteacher
David Jenner	Assistant Headteacher
Gillian Newport	EY Manager
Emma Wellard	Wellbeing Lead and Counsellor
Stephanie Box	Wellbeing Practitioner and Counsellor
Kate Taylor	Wellbeing Practitioner and Counsellor
Carrie Myhill	St Nicholas 6th Form Lead
Nuala McGill	St Nicholas at Canterbury Primary
Tracy Baldwin	St Nicholas at Spires Academy
Simon Gulliford	St Nicholas at Canterbury Academy
Julie Dimech	St Nicholas at Chartham Primary
Charlotte Wiffen	St Nicholas at Parkside Primary
Lee Gore	St Nicholas School
Gary Mayne	St Nicholas at 6th Form
Caroline Bennett	St Nicholas at Canterbury Academy

**NB: If your concern relates to a member of staff, this must, be shared with the Headteacher immediately, or in his absence the Lead DSL (or an AHT); nothing should be said to the staff member involved.**

# St Nicholas School

## Designated Safeguarding Leads



Lorna Sullivan  
l.sullivan@stns.org.uk



David Jenner  
d.jenner@stns.org.uk



Richard Dalton  
R.dalton@stns.org.uk



Gillian Newport  
g.newport@stns.co.uk



Stephen King  
s.king@stns.org.uk



Carrie Myhill  
c.myhill@stns.org.uk



Emma Wellard  
e.wellard@stns.org.uk



Stephanie Box  
s.box@stns.org.uk



K Taylor  
k.taylor@stns.org.uk